

**BEFORE THE BOARD OF SUPERVISORS
OF THE COUNTY OF YUBA**

**RESOLUTION CONCERNING THE)
COUNTY MAINTAINED MILEAGE)**

RESOLUTION NO. 2025-033

WHEREAS, Section 2121 of the Streets and Highways Code provides that in May of each year, the County shall submit to the Department of Transportation any additions to or exclusions from its mileage of maintained County roads, specifying the terminus and mileage of each route added to or excluded; and classify each of the street and road segments that the State has record of in the Highway Performance Monitoring System (HPMS) Database that corresponds to the FHWA approved California Road System (CRS) Maps coded by one or two-digit numeric Functional Classification (FC) codes; and

WHEREAS, the Department of Transportation certified to the State Controller in the year 2023 that the total mileage of maintained County roads was 661.69 miles and;

NOW THEREFORE, BE IT RESOLVED, that the total mileage of maintained County roads for 2024 is 667.62 miles, Additions, exclusions or corrections for the 2024 year are indicated in bold print on the Tabulation marked Exhibit "A". Exhibit "A" is hereby made, by reference hereto, a part of this Resolution; and

//

//

BE IT FURTHER RESOLVED, that the functionally classified street and road segments that the State has record of in the HPMS database, and that correspond to the FHWA approved CRS Maps, are coded as outlined in Exhibit "B" in the year 2024. Exhibit "B" is hereby made, by reference hereto, a part of this Resolution; and

BE IT FURTHER RESOLVED, that the functionally classified street and road segments that the State has record of in the HPMS database, and that correspond to the FHWA approved CRS Maps, are coded as shown on the map in Exhibit "C" in the year 2024. Exhibit "C" is hereby made, by reference hereto, a part of this Resolution; and

//

//

//

//

//

//

//

//

//

//

//

BE IT FURTHER RESOLVED AND ORDERED that duplicate copies of the hereinabove said Exhibit "A", Exhibit "B" and Exhibit "C" shall be filed in the office of the Clerk of the Board of Supervisors of the County of Yuba.

PASSED AND ADOPTED at a regular meeting of the Board of Supervisors of the County of Yuba, State of California on the 22 day of April, 2025 by the following vote:

AYES: Supervisors Vasquez, House, Fuhrer, Messick

NOES: None

ABSENT: Supervisor Bradford

ABSTAIN: None

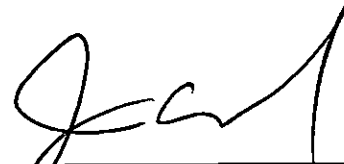

GARY BRADFORD, BOARD CHAIR
Jon Messick, Vice-Chair

ATTEST: MARY PASILLAS
CLERK OF THE BOARD OF SUPERVISORS

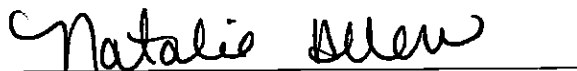

Natalie Allen, Board Clerk

Natalie Allen, Board Clerk

JANET E. BENDER
YUBA COUNTY COUNSEL
APPROVED AS TO FORM:



**EXHIBIT A
2024 YUBA COUNTY
MAINTAINED ROAD DATA**

ROAD NUMBER	ROAD NAME	FROM - NUMBER AND NAME	TO - NUMBER AND NAME	LENGTH MILES	MAP NUMBER	MAP COORDINATE	MILEAGE FROM TABS	FUNCT. CLASS
421	A RD	35 N BEALE ROAD	END	0.30	2	06D	300	7
10028	ABBEY WAY	10029 ALDERSGATE DRIVE	10030 BASINGHALL DRIVE	0.05				7
932	ABBEYLANE WAY	930 SUGARSTICK DRIVE	933 BALLANTINE WAY	0.18	2	09B	180	7
863	ABBOTSFORD COURT	867 FEATHER RIDGE DRIVE	END	0.03	2	09B	40	7
862	ABELIA COURT	857 CALABRESE WAY	END	0.02	2	09B	30	7
906	ABERDEEN COURT	849 LOHCARRON DRIVE	END	0.00	18H15	06H	3	7
106	ABERNATHY RD	PLU NF BDRY	3 FORBESTOWN RD	0.74	07G13	10H	740	7
106	ABERNATHY RD	107 OLD KNOX ROAD	PLU NF BDRY	0.30	07G13	10H	300	7
937	ABRAHAM COURT	866 CHALICE CREEK DRIVE	END	0.06	2	09B	180	7
10006	ABROZO WAY	W SUBDIVISION BOUNDRY (RON 1)	N SUBDIVISION BOUNDRY (RON 1)	0.43	2	09B	180	7
514	ACACIA WY	481 CATALPA ST	513 ASPEN WY	0.27	06H15	07E	280	7
835	AFFIRMED DRIVE	833 EGYPTIAN WAY	834 BUCKSKIN WAY	0.11	06H25	01E	120	7
359	ALBERTA AVE	35 NORTH BEALE RD	36 HMT SMTVLE RD	0.53	06H15	05G	540	7
375	ALBRECHT AVE	35 N BEALE ROAD	END	0.21	06H15	05E	220	7
10029	ALDERSGATE DRIVE	10034 FINSBURY WAY	10036 LONDON WAY	0.25				7
405	ALGODON RD	44 RIVER OAKS BLVD	25 PLUMAS ARBOGA RD	0.39	06H25	07F	170	5
405	ALGODON RD	43 FEATHER RIVER BLV	405 ALGODON RD	2.27	06H25	10C	2270	7
405	ALGODON RD	405 ALGODON ROAD	44 RIVEROAKS BLVD	0.08	06H25	08E	300	7
317	ALICIA AVE	43 FEATHER RIVER BLV	23 GRAND AVE	0.43	06H15	06C	430	5
317	ALICIA AVE	23 GRAND AVE	321 PASADO RD	0.27	06H15	07C	280	7
317	ALICIA AVE	441 RIVERSIDE DR	43 FEATHER RIVER BLV	0.42	06H15	06B	430	7
168	ALLEGHANY RD	SH049	S180 SIE CO RD	2.49	07G	05H	2490	7
312	ALMOND AVE	441 RIVERSIDE DR	311 POPLAR AVE	0.09	06H15	05B	90	7
397	ALPINE WAY	35 N BEALE ROAD	373 E PARK AVE	0.26	06H15	05E	260	7
738	AMARANTH STREET	736 BAMBOO STREET	739 VELVET LEAF STREET	0.23	06H25	03D	232	7
760	AMARILLO COURT	761 DRY GULCH TRAIL DRIVE	END	0.05	06H25	08F	50	7
235	AMES RD	233 LAURELLEN RD	END	0.37	06G	08H	370	7
799	ANCHOR BAY WAY	801 STINSON WAY	797 SANTA CRUZ DRIVE	0.05	2	09B	50	7
303	ANDERSON AVE	EAST LINE TR/LIA SETBACK LEVEE R/W	END	0.59	06H25	06A	1400	7
653	ANGELICA WAY	619 MCCARTHY AVE	616 BARNEY AVE	0.17	06H25	01F	170	7
795	ANNADEL COURT	788 WESTPORT WAY	END	0.04	2	09B	40	7
707	APPALOOSA RANCH COURT	706 THUNDER RANCH	END	0.06	06H25	08F	60	7
638	APTOS CREEK COURT	635 BIDWELL BAR DRIVE	END	0.10	06H25	08F	100	7
22	ARBOGA RD	37 BROADWAY	25 PLUMAS ARBOGA	0.30	06H25	04E	300	5
22	ARBOGA RD	25 PLUMAS ARBOGA	32 MCGOWAN PKWY	1.45	06H25	04E	1450	5
22	ARBOGA RD	32 MC GOWAN PKWY	43 FEATHER RIVER BLV	3.60	06H25	01E	3600	5
498	ARCANO AVE	496 MAPLEHURST ST	SOUTH SUBDIVISION BOUNDARY	0.28	06H25	02F	90	7
498	ARCANO AVE	NORTH SUBDIVISION BOUNDARY	SOUTH SUBDIVISION BOUNDARY	0.06	06H25	02F	60	7
354	ARDMORE AVE	347 NINTH AVE	32 MCGOWAN PKWY	1.00	06H15	09E	1000	7
688	ARLINGTON WAY	687 NOTTING HILL WAY	697 ISLESWORTH WAY	0.07	06H25	10E	70	7
228	ARMSTRONG RD	14 WOODRUFF LANE	END	0.63	06G55	04A	630	7
427	ASH WAY	369 GROVE AVE	485 PARK CIRCLE	0.37	06H15	05E	370	7
747	ASPEN PEAK STREET	743 MEADOW RANCH STREET	780 SNOWY EGRET STREET	0.06	06H25	03D	30	7
513	ASPEN WY	483 HICKORY LN	444 CHESTNUT RD	0.48	06H15	07E	480	7
618	ASTER COURT	653 ANGELICA WAY	END	0.04	06H25	01F	40	7
787	ATHERTON WAY	END	END	0.42	2	09B	420	7
787	ATHERTON WAY	W SUBDIVISION BOUNDRY (PLUMAS RANCH V. 6)	922 LOS ALTOS COURT	0.03				7
676	AUGUST WAY	678 JUNE WAY	336 ROSE AVENUE	0.25	06H25	11G	250	7

**EXHIBIT A
2024 YUBA COUNTY
MAINTAINED ROAD DATA**

ROAD NUMBER	ROAD NAME	FROM - NUMBER AND NAME	TO - NUMBER AND NAME	LENGTH MILES	MAP NUMBER	MAP COORDINATE	MILEAGE FROM TABS	FUNCT. CLASS
878	AUTUMN LANE	882 FREESTONE DRIVE	883 SEEDLING WAY	0.08	06H15	06H	80	7
878	AUTUMN LANE	921 HARCREST DRIVE	923 SUNHAVEN STREET	0.11	06H15	06H	110	7
679	AVERY STREET	677 SUMMERFIELD LANE	676 AUGUST WAY	0.06	06H25	11G	60	7
524	AVOCET DR	522 EAGLE LN	523 FAIRWAY DR	0.20	06H25	05E	200	7
370	AVONDALE AVE	36 HMT SMTVLE RD	35 N BEALE RD	0.30	06H15	06D	300	5
370	AVONDALE AVE	35 N BEALE RD	END	0.29	06H15	05D	290	7
262	BABBINGTON RD	17 SIMPSON LANE	END	0.85	06H15	04D	850	7
10009	BABCOCK WAY	W SUBDIVISION BOUNDRY (RON 1)	10006 ABROZO WAY	0.07	2	09B	180	7
10009	BABCOCK WAY	929 DUSTY MAIDEN DRIVE	E SUBDIVISION BOUNDRY (RON 2)	0.02	2	09B	180	7
10013	BACALL COURT	929 DUSTY MAIDEN DRIVE	END	0.07	2	09B	180	7
864	BAIRDSLEY COURT	867 FEATHER RIDGE DRIVE	END	0.11	2	09B	110	7
158	BAKER RD	FOREST BDRY	END	1.10	07G	03G	1100	7
158	BAKER RD	125 GARDEN VALLEY	FOREST BDRY	1.90	07G	03H	1900	7
219	BALD MT RD	8 MARYSVILLE RD	9 PEORIA RD	1.90	07G	08B	1900	7
10007	BALDWIN WAY	10011 CALLISON WAY	W SUBDIVISION BOUNDRY (RON 1)	0.11	2	09B	180	7
933	BALLANTINE WAY	N SUBDIVISION BOUNDRY (ROE 2)	934 JADESTON WAY	0.11	2	09B	180	7
933	BALLANTINE WAY	930 SUGARSTICK DRIVE	S SUBDIVISION BOUNDRY (ROE 3)	0.14	2	09B	180	7
736	BAMBOO STREET	735 YARROW STREET	744 MORNING GLORY STREET	0.33	06H25	03D	33	7
616	BARNEY AVENUE	653 ANGELICA WAY	621 BLUEBELL AVE	0.07	06H25	01F	70	7
141	BARTON HILL RD	1 LA PORTE RD	1 LA PORTE RD	1.42		04G	1420	5
141	BARTON HILL RD	1 LA PORTE RD	BUT CO	0.42	1	04G	2250	7
10030	BASINGHALL DRIVE	10034 FINSBURY WAY	10028 ABBEY WAY	0.20				7
419	BAUGH ST	31 OLIVEHURST AVE	354 ARDMORE AVE	0.10	06H25	01F	100	7
419	BAUGH ST	354 ARDMORE AVE	355 FLEMING WAY	0.13	06H25	01F	130	7
419	BAUGH ST	355 FLEMING WAY	357 POWERLINE RD	0.25	06H25	01F	250	7
908	BAYMONT CT	909 HEARTLAND DR	END	0.02	06H25	10F	20	7
479	BAYWOOD WAY	469 FERNWOOD DR	END	0.07	06H15	06E	30	7
110	BEAN CLIPPER RD	1 LA PORTE RD	1 LA PORTE RD	3.00	07G	02F	3000	7
110	BEAN CLIPPER RD	1 LA PORTE RD	1 LA PORTE RD	6.20	07G	02F	6200	7
411	BEAVER LANE	346 EIGHTH AVE	345 SEVENTH AVE	0.13	06H15	09E	130	7
770	BEDROCK COURT	767 POTOMAC WAY	END	0.06	2	09B	60	7
448	BEDE AVE	35 N BEALE ROAD	451 SIERRA WAY	0.10	06H15	05F	100	7
870	BEFORD STREET	869 TARRANT DRIVE	W SUBDIVISION BOUNDRY	0.10	06H25	02E	100	7
622	BELLIS COURT	31 OLIVEHURST AVE	END	0.08	06H25	01F	80	7
686	BELVEDERE WAY	682 KENSINGTON DRIVE	681 LEIGHTON GROVE DRIVE	0.27	06H25	10E	270	7
891	BERMUDA DRIVE	892 SAINT ANDREWS DRIVE	890 ROSS RANCH CIRCLE	0.40	06H25	06F	400	7
338	BERNICE AVE	URBAN LIMIT	END	0.85	06H25	01J	850	7
338	BERNICE AVE	20 RANCHO RD	URBAN LIMIT	0.03	06H25	01J	30	7
951	BERRYESSA WAY	952 HENNESSEY WAY	S SUBDIVISION BOUNDRY	0.07	06H35	04G	70	7
951	BERRYESSA WAY	NORTH SUBDIVISION BOUNDARY (ROS 2)	971 SILVER CREEK CIRCLE	0.16	2	09B	180	7
668	BERTAS COURT	635 BIDWELL BAR DRIVE	END	0.11	06H25	08F	110	7
252	BEVAN RD	10 LOMA RICA ROAD	END	0.88	07G41	02G	880	7
394	BEVERLY AVE	31 OLIVEHURST AVE	357 POWERLINE ROAD	0.49	06H25	01F	490	7
394	BEVERLY AVE	31 OLIVEHURST AVE	621 BLUEBELL AVE	0.03	06H25	01F	30	7
635	BIDWELL BAR DRIVE	634 OREGON CREEK WAY	673 HIGH NOON DRIVE	0.62	06H25	08F	410	7
499	BIGLOW DR	END	END	0.26	06H25	02F	259	7
365	BINGHAM AVE	21 LINDHURST AVE	443 PACKARD AVE	0.14	06H15	06D	140	7

**EXHIBIT A
2024 YUBA COUNTY
MAINTAINED ROAD DATA**

ROAD NUMBER	ROAD NAME	FROM - NUMBER AND NAME	TO - NUMBER AND NAME	LENGTH MILES	MAP NUMBER	MAP COORDINATE	MILEAGE FROM TABS	FUNCT. CLASS
476	BIRCH CT	469 FERNWOOD DR	END	0.04	06H15	06F	40	7
560	BLACK ANGUS WY	543 DONALD DR	541 DEATON DR	0.15	06H25	01F	150	7
165	BLACKFORD RD	42 CAMP FAR WEST	PLA CO	0.40	2	07F	400	7
880	BLOOM DRIVE	885 CLING DRIVE	659 RIVERBANK DRIVE	0.24	06H15	06H	240	7
247	BLUE GRAVEL RD	19 SMARTVILLE RD	1025 BLUE GRAVEL RD	0.11	07G53	06A	110	7
621	BLUEBELL AVENUE	619 MCCARTHY AVE	616 BARNEY AVE	0.09	06H25	01F	90	7
782	BLUEGRASS STREET	855 LINKS PARKWAY	784 FIDDLENECK STREET	0.25	06H25	03D	250	7
927	BLUE JAY COURT	814 PURPLE MARTIN ROAD	END	0.03	06H25	02F	30	7
661	BOARDWALK DRIVE	660 POPPY WAY	576 RIVER RUN DRIVE	0.25	06H15	06E	250	7
10018	BOB HAYES DRIVE	876 PITTENGER DRIVE	W SUBDIVISION BOUNDRY (DRN 2)	0.11	06H25	02E	60	7
458	BOMANN DR	418 FOURTEENTH ST	END	0.18	06H15	10F	180	7
10032	BOND WAY	10033 CAMOMILE DRIVE	681 LEIGHTON GROVE DRIVE	0.07				7
928	BORDEAUX COURT	930 SUGARSTICK DRIVE	END	0.09	2	09B	180	7
982	BOSWELL WAY	682 KENSINGTON DRIVE	687 NOTTING HILL WAY	0.05				7
249	BOYER RD	SH070	END	0.31	06G	08H	310	7
415	BRADLEY	306 MYRNA AVE	END	0.05	06H15	08C	50	7
332	BRADSHAW RD	END	334 OSTROM ROAD	2.20	2	07D	2200	7
884	BRANCH WAY	887 PEACH TREE DRIVE	881 COBBLER LANE	0.15	06H15	06H	150	7
282	BRANDIE DR	10 LOMA RICA RD	283 DAWN DR	0.65	07G	07B	650	7
669	BRANDING IRON WAY	631 TABLE MOUNTAIN DRIVE	673 HIGH NOON DRIVE	0.36	06H25	08F	360	7
587	BRENT DRIVE	544 SUTTER ST	END	0.27	06H15	05G	270	7
723	BRIANNA AVENUE	724 SEYKOTA AVENUE	726 SUNDARI AVENUE	0.10	06H25	01F	100	7
988	BRIDLE CREEK WAY	WEST SUBDIVISION BOUNDARY (RM 3)	986 SUMMERWIND COURT	0.13				7
633	BRIDGEPORT WAY	44 RIVER OAKS BLVD	635 BIDWELL BAR DRIVE	0.12	06H25	08F	120	7
607	BROAD ACRES WAY	602 WILCOX RANCH ROAD	END	0.24	06H25	08F	240	7
302	BROADWAY	EAST LINE TRIA SETBACK LEVEE RW	END	1.95	06H25	04E	2800	7
853	BROKEN BIT DRIVE	669 BRANDING IRON WAY	909 HEARTLAND DR	0.25	06H25	09F	150	7
708	BROKEN SPUR WAY	606 COFFEE CREEK WAY	712 SLINGSHOT DRIVE	0.48	08H25	08F	480	7
916	BROMLEY COURT	915 IVY HATCH WAY	END	0.08	06H35	02F	80	7
709	BRONCO DRIVE	606 COFFEE CREEK WAY	712 SLINGSHOT DRIVE	0.39	06H25	08F	390	7
538	BROOKGLEN DR	499 BIGLOW DR	658 SOPHIA STREET	0.24	06H25	02F	88	7
376	BROPHY RD	35 N BEALE ROAD	36 HMT SMTVLE RD	1.60	2	06C	1600	7
497	BROUGHAM WAY	496 MAPLEHURST ST	END	0.09	06H25	02F	90	7
218	BROWNS VALLEY SCHOOL RD	SH020	8 MARYSVILLE RD	0.75	07G	09B	750	7
420	BRYDEN RD	36 HMT SMTVLE RD	END	0.37	06H15	03K	370	7
834	BUCKSKIN WAY	22 ARBOGA ROAD	830 CITATION DRIVE	0.13	06H25	01E	130	7
410	BURDICK RD	304 CNTRY CLUB RD	END	0.32	06H25	06D	320	7
575	BUTLER DR	544 SUTTER ST	546 COLLEGE VIEW DR	0.20	06H15	04F	200	7
597	BUTTER MILK COURT	592 INDEPENDENCE TRAIL	END	0.05	06H25	08F	50	7
493	BUTTERCUP LN	22 ARBOGA ROAD	491 BUTTERFLY LN	0.45	06H25	01E	450	7
491	BUTTERFLY LN	22 ARBOGA ROAD	493 BUTTERCUP LN	0.39	06H25	01E	390	7
931	CABERNET WAY	930 SUGARSTICK DRIVE	N SUBDIVISION BOUNDRY (ROE 3)	0.07	2	09B	180	7
931	CABERNET WAY	10006 ABROZO WAY	S SUBDIVISION BOUNDRY (RON 1)	0.03	2	09B	180	7
672	CACTUS DRIVE	668 BERTAS COURT	669 BRANDING IRON WAY	0.20	06H25	08F	200	7
857	CALABRESE WAY	866 CHALICE CREEK DRIVE	859 EARHART WAY	0.14	2	09B	140	7
561	CALISTOGA DR	543 DONALD DR	541 DEATON DR	0.15	06H25	01F	150	7
10011	CALLISON WAY	10006 ABROZO WAY	10009 BABCOCK WAY	0.20	2	09B	180	7

**EXHIBIT A
2024 YUBA COUNTY
MAINTAINED ROAD DATA**

ROAD NUMBER	ROAD NAME	FROM - NUMBER AND NAME	TO - NUMBER AND NAME	LENGTH MILES	MAP NUMBER	MAP COORDINATE	MILEAGE FROM TABS	FUNCT. CLASS
150	CALVIN LN	146 CLEVELAND AVE	145 SPENCER ST	0.06	07G1	04A	60	7
605	CALYPSO RANCH DRIVE	606 COFFEE CREEK WAY	604 GOLD NUGGET WAY	0.45	06H25	08F	450	7
10033	CAMOMILE DRIVE	10034 FINSBURY WAY	10032 BOND WAY	0.30				
42	CAMP FAR WEST RD	40 SPENCEVILLE RD	41 LONG RAVINE RD	6.60	2	07F	6600	6
42	CAMP FAR WEST RD	41 LONG RAVINE RD	NEV CO	1.02	2	07G	1020	7
143	CAMPTONVILLE ST	146 CLEVELAND AVE	SH049	0.09	07G1	04A	90	7
985	CANADIAN WAY	768 PEARL WAY INTERSECTION	987 SOUTH SHORE WAY INTERSECTION	0.11				7
352	CANAL ST	343 FIFTH AVE	341 THIRD AVE	0.19	06H15	08E	190	7
936	CANFIELD COURT	930 SUGARSTICK DRIVE	END	0.05	2	09B	180	7
947	CANNING WAY	948 WOODLET STREET	949 HARVEST STREET	0.05	06H25	06H	50	7
981	CANNON COURT	698 STEPNEY WAY	END	0.03				7
593	CANYON CREEK TRAIL	592 INDEPENDENCE TRAIL	589 SECRET LAKE TRAIL	0.29	06H25	08F	290	7
699	CAREY COURT	697 ISLESWORTH WAY	END	0.03	06H25	10E	30	7
10019	CARL LEWIS DRIVE	10017 JIM HINES DRIVE	S SUBDIVISION BOUNDRY (DRN 2)	0.03	06H25	02E	60	7
10015	CARMEN COURT	E SUBDIVISION BOUNDRY (RON 2)	END	0.03	2	09B	180	7
942	CARRINGTON COURT	934 JADESTON WAY	END	0.06	2	09B	180	7
611	CASA DULCE WAY	613 LINDENMEIR DRIVE	602 WILCOX RANCH ROAD	0.27	06H25	08F	270	7
481	CATALPA ST	444 CHESTNUT RD	513 ASPEN WY	0.23	06H15	07E	230	7
563	CATTAIL CT	364 RUPERT AVE	END	0.12	06H15	06E	120	7
564	CATTAIL DR	364 RUPERT AVE	571 TWISTED RIVER DR	0.37	06H15	06E	370	7
860	CAVANAUGH COURT	866 CHALICE CREEK DRIVE	END	0.06	2	09B	60	7
545	CECILIA WY	544 SUTTER ST	546 COLLEGE VIEW DR	0.12	06H15	05F	123	7
314	CEDAR LANE	317 ALICIA AVE	315 GARDEN AVE	0.25	06H15	06B	250	7
128	CELESTIAL VLY RD	159 RIDGE ROAD	END	0.81	07G	05H	810	7
866	CHALICE CREEK DRIVE	N SUBDIVISION BOUNDRY	S SUBDIVISION BOUNDRY	0.28	2	09B	280	7
866	CHALICE CREEK DRIVE	867 FEATHER RIDGE DRIVE	N SUBDIVISION BOUNDRY (ROS 1)	0.18	2	09B	180	7
866	CHALICE CREEK DRIVE	N SUBDIVISION BOUNDRY (ROS 2)	969 KNOTTY PINE WAY	0.03	2	09B	180	7
866	CHALICE CREEK DRIVE	N SUBDIVISION BOUNDRY (ROS 3)	972 JAMISON CREEK WAY	0.10	2	09B	180	7
866	CHALICE CREEK DRIVE	930 SUGARSTICK DRIVE	S SUBDIVISION BOUNDRY (ROE 2)	0.10	2	09B	180	7
6	CHALLENGE CUT OFF	BUT CO	1 LA PORTE RD	2.41	07G13	09D	2410	5
263	CHANDLER RD	SH070	END	0.50	06G	06H	500	7
356	CHAPMAN AVE	355 FLEMING WAY	END	0.14	06H15	09F	140	7
537	CHATEAU DR	499 BIGLOW DR	658 SOPHIA STREET	0.23	06H25	02F	76	7
10005	CHELSEA COURT	898 MINORIES DRIVE	END	0.06				7
444	CHESTNUT RD	33 ERLE RD	31 OLIVEHURST AVE	1.01	06H15	07D	1010	7
444	CHESTNUT RD	37 HMT SMTVLE RD W	33 ERLE RD	0.74	06H15	06C	740	7
926	CHUCKAR COURT	814 PURPLE MARTIN ROAD	END	0.03	06H25	02F	30	7
907	CHUCK YEAGER RD	36 HAMMONTON SMARTSVILLE RD	1017 (BEALE AFB)	6.69	07G	10D	6690	5
246	CHURCH LANE	245 OBRIEN ROAD	247 BLUE GRAVEL RD	0.08	07G53	05A	80	7
685	CHURCHILL WAY	681 LEIGHTON GROVE DRIVE	MINORIES DRIVE	0.27	06H25	10E	240	7
765	CIMARRON DRIVE	44 RIVER OAKS BLVD	END	0.29	2	09B	290	7
114	CISSANO RD	SH049	END	0.00	1	05H	90	7
830	CITATION DRIVE	828 IRISH DRAUGHT WAY	834 BUCKSKIN WAY	0.34	06H25	01E	340	7
728	CLARICE AVENUE	726 SUNDARI AVENUE	31 OLIVEHURST AVE	0.03	06H25	01F	30	7
902	CLARIDGE COURT	901 GARNET WAY	END	0.01	2	09C	10	7
627	CLEAR WATER COURT	625 RAPID WATER WAY	END	0.07	06H25	06F	70	7
146	CLEVELAND AVE	SH049	115 MT HOUSE RD	0.73	07G1	02A	730	7

**EXHIBIT A
2024 YUBA COUNTY
MAINTAINED ROAD DATA**

ROAD NUMBER	ROAD NAME	FROM - NUMBER AND NAME	TO - NUMBER AND NAME	LENGTH MILES	MAP NUMBER	MAP COORDINATE	MILEAGE FROM TABS	FUNCT. CLASS
885	CLING DRIVE	887 PEACH TREE DRIVE	880 BLOOM DRIVE	0.09	06H15	06H	90	7
962	COASTLINE COURT	967 RIO GRANDE DRIVE	END	0.07	2	09B	290	7
881	COBBLER LANE	880 BLOOM DRIVE	659 RIVERBANK DRIVE	0.23	06H15	06H	230	7
881	COBBLER LANE	659 RIVER BANK DRIVE	949 HARVEST STREET	0.11	06H25	06H	110	7
565	COBBLESTONE DRIVE	570 TADPOLE WAY	467 OAKWOOD DRIVE	0.47	06H15	06E	470	7
606	COFFEE CREEK WAY	607 BROAD ACRES WAY	600 ZANES DRIVE	0.71	06H25	08F	200	7
313	COHN AVE	310 SYCAMORE AVE	314 CEDAR LANE	0.31	06H15	05B	310	7
273	COLLEEN CT	271 VICKIE DR	END	0.09	07G41	04F	90	7
546	COLLEGE VIEW DR	35 NORTH BEALE RD	END	0.20	06H15	05G	204	7
339	COLLEGE WAY	394 BEVERLY AVE	418 FOURTEENTH ST	0.39	06H25	01F	390	7
269	COLLINS LAKE RD	8 MARYSVILLE RD	END	0.20	07G	06C	200	7
772	COLORADO DRIVE	44 RIVER OAKS BLVD	44 RIVER OAKS BLVD	0.39	2	09B	390	7
775	COLUMBIA WAY	772 COLORADO DRIVE	END	0.07	2	09B	70	7
695	COPLEY WAY	673 HIGH NOON DR	684 PADDINGTON WAY	0.12	06H25	10E	30	7
533	COPPER LEAF CT	532 GOLD LEAF WY	END	0.04	06H25	01G	40	7
809	CORDOZA DRIVE	806 PHEASANT RUN DRIVE	END	0.04	625	03E	40	7
559	CORNFIELD WY	543 DONALD DR	541 DEATON DR	0.15	06H25	01F	150	7
151	COSTA RD	1 LA PORTE RD	END	1.25	07G1	03F	1250	7
319	COTTONWOOD AVE	23 GRAND AVE	441 RIVERSIDE DR	0.40	06H15	07C	400	7
472	COUNTRY CLUB CT	464 WOODLAND DR	END	0.08	06H15	05F	80	7
304	COUNTRY CLUB RD	EAST LINE TRLIA SETBACK LEVEE RAW	43 FEATHER RIVER BLV	0.55	06H25	06A	1170	7
304	COUNTRY CLUB RD	43 FEATHER RIVER BLV	304 CNTRY CLUB RD	0.48	06H25	06C	480	7
304	COUNTRY CLUB RD	304 CNTRY CLUB RD	END	0.52	06H25	06D	520	7
839	COUNTRY CREEK COURT	825 STONEY CREEK WAY	END	0.04	06H15	06G	40	7
169	COUNTY ROAD 169	PLU NF BDRY	END	1.00	07G	05G	1000	7
169	COUNTY ROAD 169	129 OREGON HILL RD	PLU NF BDRY	0.31	07G	05G	310	7
171	COUNTY ROAD 171	146 CLEVELAND AVE	END	0.02	07G1	04B	20	7
172	COUNTY ROAD 172	8 MARYSVILLE RD	END	0.28	1	07G	280	7
270	COUNTY ROAD 270	8 MARYSVILLE RD	END	0.97	07G	06D	970	7
276	COUNTY ROAD 276	10 LOMA RICA RD	END	0.83	07G41	10A	830	7
512	COUNTY ROAD 512	43 FEATHER RIVER RD	END	0.59	06H	05J	590	7
484	CRESS WAY	483 HICKORY LANE	483 HICKORY LN	0.17	06H15	07E	170	7
692	CROFT COURT	681 LEIGHTON GROVE DRIVE	END	0.04	06H25	10E	40	7
913	CROSS STAR TRAIL	10 LOMA RICA ROAD	END	0.06	7G	07C	60	7
979	CROWDER WAY	898 MINORIES DRIVE	NW SUBDIVISION BDRY (PLUMAS LAKE PH 4)	0.07				7
979	CROWDER WAY	898 MINORIES DRIVE	S SUBDIVISION BDRY (PLUMAS LAKE PH 5)	0.16				7
700	CROYDON COURT	687 NOTTING HILL WAY	END	0.07	06H25	10E	70	7
730	CRYSTAL COURT	733 SHAY AVENUE	END	0.03	06H25	01F	30	7
802	CURRENT COURT	479 BAYWOOD DRIVE	END	0.04	06H15	06G	40	7
943	DAIMLER COURT	931 CABERNET WAY	END	0.05	2	09B	180	7
27	DAIRY RD	SH065	26 FORTY MILE RD	2.88	2	08D	2880	7
620	DAISY AVENUE	619 MCCARTHY AVE	END	0.05	06H25	01F	20	7
335	DAN AVE	32 MC GOWAN PKWY	END	0.39	06H25	01G	390	7
858	DANFORTH WAY	857 CALABRESE WAY	866 CHALICE CREEK DRIVE	0.10	2	09B	100	7
387	DANTONI RD	URBAN LIMIT	END	1.95	06H15	03G	1950	7
387	DANTONI RD	36 HMT SMTVLE RD	URBAN LIMIT	0.51	06H15	04G	510	7
181	DARK DAY RD	8 MARYSVILLE RD	END	0.33	1	07G	330	7

**EXHIBIT A
2024 YUBA COUNTY
MAINTAINED ROAD DATA**

ROAD NUMBER	ROAD NAME	FROM - NUMBER AND NAME	TO - NUMBER AND NAME	LENGTH MILES	MAP NUMBER	MAP COORDINATE	MILEAGE FROM TABS	FUNCT. CLASS
614	DARK HORSE WAY	600 ZANES DRIVE	44 RIVER OAKS BLVD	0.19	06H25	08F	190	7
501	DAUGHERTY RD	907 CHUCK YEAGER RD	END	0.29	2	04G	290	7
540	DAVID LN	302 BROADWAY	END	0.22	06H25	05D	220	7
251	DAVIS RD	17 SIMPSON LANE	END	0.60	06H15	03C	600	7
283	DAWN DR	282 BRANDIE DR	279 KIMBERLY RD	1.04	07G	07B	1040	7
541	DEATON DR	32 MC GOWAN PKWY	561 CALISTOGA DR	0.45	06H25	01F	452	7
503	DEBORAH LANE	855 KENT WAY	516 MAYWOOD DR	0.25	06H15	05E	170	7
177	DEERCLIFF CT	174 IDLEWOOD CIR	END	0.08	07G13	10B	80	7
746	DEERWOOD STREET	742 HUNTER'S CREEK STREET	745 TRAIL LEAF STREET	0.23	06H25	03D	230	7
789	DEL NORTE WAY	787 ATHERTON WAY	END	0.03	2	09B	30	7
789	DEL NORTE WAY	W SUBDIVISION BDRY (PLUMAS RANCH VILLAGE 6)	992 PALO ALTO CT / 989 PACIFIC GROVE WAY INT.	0.07				7
281	DENNIS DR	279 KIMBERLY RD	283 DAWN DR	0.30	07G	07B	300	7
536	DEREK DR	442 FIR RD	444 CHESTNUT RD	0.22	06H15	07D	216	7
10003	DEVON COURT	898 MINORIES DRIVE	END	0.05				7
529	DIANE WY	527 LISA WY	END	0.10	06H15	05D	100	7
261	DIGGINGS RD	19 SMARTVILLE RD	END	0.24	2	09G	240	7
435	DIVOT ST	304 CNTRY CLUB RD	END	0.07	06H25	06E	70	7
173	DIXON HILL RD	138 TEXAS HILL RD	1054	1.00	07G	06E	1000	7
234	DOC ADAMS RD	233 LAURELLEN RD	END	0.50	06G55	10A	500	7
367	DODSON AVE	368 MONTCLAIR AVE	END	0.10	06H15	05D	100	7
220	DOLAN HARDING RD	9 PEORIA ROAD	8 MARYSVILLE RD	3.35	07G	07C	3350	7
543	DONALD DR	32 MCGOWAN PKWY	END	0.51	06H25	01F	510	7
940	DONCASTER COURT	867 FEATHER RIDGE DRIVE	END	0.09	2	09B	180	7
280	DORI CT	279 KIMBERLY RD	END	0.12	07G	07C	120	7
790	DOS RIOS COURT	787 ATHERTON WAY	END	0.05	2	09B	50	7
811	DOVE DRIVE	806 PHEASANT RUN DRIVE	END	0.03	625	03E	30	7
601	DRAKES BAR COURT	602 WILCOX RANCH ROAD	END	0.05	06H25	08F	50	7
963	DRIFTWOOD COURT	967 RIO GRANDE DRIVE	END	0.05	2	09B	290	7
330	DRY CREEK LEVEE RD	SH065	29 OAKLEY LANE	0.54	2	08D	540	7
761	DRY GULCH TRAIL DRIVE	606 COFFEE CREEK WAY	614 DARK HORSE WAY	0.37	06H25	08F	370	7
358	DUGGIN ST	33 ERLE ROAD	END	0.30	06H15	08K	300	7
729	DUKES COURT	726 SUNDARI AVENUE	END	0.05	06H25	01F	50	7
807	DUNCAN DRIVE	806 PHEASANT RUN DRIVE	END	0.04	625	03E	40	7
380	DUNNING AVE	360 LINDA AVENUE	END	0.44	06H15	05F	440	7
649	DUNSMUIR WAY	648 LAKEPORT WAY	44 RIVER OAKS BLVD	0.21	06H25	08F	210	7
873	DUNWOODY DRIVE	22 ARBOGA ROAD	875 HUSTON WAY	0.16	06H25	02E	160	7
784	DURANGO COURT	711 MORGAN DRIVE	END	0.06	06H25	08F	60	7
696	DURHAM COURT	684 PADDINGTON WAY	END	0.03	06H25	10E	30	7
929	DUSTY MAIDEN DRIVE	930 SUGARSTICK DRIVE	N SUBDIVISION BOUNDRY (ROE 3)	0.11	2	09B	180	7
929	DUSTY MAIDEN DRIVE	S SUBDIVISION BOUNDRY (RON 1)	N SUBDIVISION BOUNDRY (RON 1)	0.11	2	09B	180	7
929	DUSTY MAIDEN DRIVE	N SUBDIVISION BOUNDRY (RON 2)	S SUBDIVISION BOUNDRY (RON 2)	0.22	2	09B	180	7
424	DYE RD	302 BROADWAY	522 EAGLE LN	0.55	06H25	05E	550	7
373	E PARK AVE	372 PARK AVENUE	END	0.12	06H15	05D	120	7
522	EAGLE LN	523 FAIRWAY DR	END	0.14	06H25	06E	140	7
859	EARHART WAY	857 CALABRESE WAY	866 CHALICE CREEK DRIVE	0.10	2	09B	100	7
207	EAST BURRIS RD	11 FRUITLAND RD	END	0.36	07G	03J	360	7
566	EDGEWATER CIR	33 ERLE RD	33 ERLE RD	0.98	06H15	06E	440	5

**EXHIBIT A
2024 YUBA COUNTY
MAINTAINED ROAD DATA**

ROAD NUMBER	ROAD NAME	FROM - NUMBER AND NAME	TO - NUMBER AND NAME	LENGTH MILES	MAP NUMBER	MAP COORDINATE	MILEAGE FROM TABS	FUNCT. CLASS
642	EDWARDS COURT	641 KNIGHTS FERRY DRIVE	END	0.11	06H25	08F	110	7
833	EGYPTIAN WAY	835 AFFIRMED DRIVE	E SUBDIVISION BOUNDRY	0.13	06H25	01E	130	7
519	EIGHTEENTH AVE	354 ARDMORE AVE	355 FLEMING WAY	0.13	06H25	01F	130	7
519	EIGHTEENTH AVE	355 FLEMING WAY	357 POWERLINE RD	0.24	06H25	01F	240	7
346	EIGHTH AVE	357 POWERLINE RD	END	0.82	06H15	09F	820	7
626	ELDERBERRY COURT	625 RAPID WATER WAY	END	0.04	06H15	09F	40	7
349	ELEVENTH AVE	31 OLIVEHURST AVE	357 POWERLINE RD	0.50	06H15	10F	500	5
349	ELEVENTH AVE	351 WESTERN AVE	31 OLIVEHURST AVE	0.26	06H15	10E	260	7
349	ELEVENTH AVE	22 ARBOGA RD	353 PACIFIC AVE	0.11	06H15	10D	110	7
309	ELINOR AVE	308 ELIZABETH AVE	END	0.12	06H15	08B	120	7
308	ELIZABETH AVE	307 VIRGINIA AVE	END	0.20	06H15	08B	200	7
10012	ELKINS CIRCLE	929 DUSTY MAIDEN DRIVE	929 DUSTY MAIDEN DRIVE	0.17	2	09B	180	7
323	ELLA AVE	22 ARBOGA ROAD	END	1.50	06H25	02E	1500	7
938	ELLESWORTH COURT	866 CHALICE CREEK DRIVE	END	0.05	2	09B	180	7
231	ELLIS RD	SH070	15 JACK SLOUGH RD	1.53	06G55	07A	1530	7
477	ELMWOOD CT	469 FERNWOOD DR	END	0.04	06H15	06F	40	7
515	ELTON AVE	485 LEVER AVE	460 EVELYN DR	0.12	06H25	01G	120	7
599	EMPIRE COURT	592 INDEPENDENCE TRAIL	END	0.09	06H25	08F	90	7
741	EMPRESS STREET	855 LINKS PARKWAY	735 YARROW STREET	0.03	06H25	03D	30	7
954	ENGBRIGHT WAY	957 KIRKWOOD COURT	866 CHALICE CREEK DRIVE	0.07	06H35	04G	70	7
871	ENGLISH WAY	870 BEFORD STREET	872 MC ALISTER COURT	0.14	06H25	02E	140	7
33	ERLE RD	URBAN LIMIT	1019 BEALE AFB BDRY	5.46	06H15	07H	5460	6
33	ERLE RD	21 LINDHURST AVE	33 ERLE RD	0.06	06H15	07D	60	5
33	ERLE RD	33 ERLE RD	URBAN LIMIT	1.84	06H15	07E	1840	5
33	ERLE RD	22 ARBOGA RD	21 LINDHURST AVE	0.34	06H15	07D	340	7
654	EUGENE DRIVE	657 MARYCLAIR DRIVE	832 FALABELLA WAY	0.28	06H25	11E	110	7
460	EVELYN DR	32 MC GOWAN PKWY	515 ELTON AVE	0.52	06H25	01G	520	7
980	EXETER COURT	915 IVY HATCH WAY	END	0.04				7
960	FAIRTIME COURT	923 SUNHAVEN STREET	END	0.06	06H15	06H	90	7
523	FAIRWAY DR	END	END	0.18	06H25	06E	180	7
832	FALABELLA WAY	654 EUGENE DRIVE	E SUBDIVISION BOUNDRY	0.13	06H25	01E	130	7
714	FALL RIVER DRIVE	479 BAYWOOD DRIVE	719 WATERFRONT COURT	0.50	06H15	06F	500	7
175	FALLEN LEAF CT	174 IDLEWOOD CIR	END	0.02	07G13	10B	22	7
362	FARRELL WAY	363 MAPES WAY	36 HMT SMTVLE RD	0.20	06H15	04E	200	7
867	FEATHER RIDGE DRIVE	NW SUBDIVISION BOUNDRY	S SUBDIVISION BOUNDRY	0.13	2	09B	130	7
867	FEATHER RIDGE DRIVE	866 CHALICE CREEK DRIVE	N SUBDIVISION BOUNDRY (ROS 1)	0.25	2	09B	250	7
867	FEATHER RIDGE DRIVE	935 GARLINGTON WAY	S SUBDIVISION BOUNDRY (ROE 2)	0.02	2	09B	180	7
43	FEATHER RIVER BLVD	SH070	URBAN LIMITS	10.65	06H15	09C	10650	5
43	FEATHER RIVER BLVD	URBAN LIMIT	35 N BEALE ROAD	2.25	06H15	05C	2250	5
640	FELTON WAY	635 BIDWELL BAR DRIVE	END	0.15	06H25	08F	150	7
475	FERN CT	469 FERNWOOD DR	END	0.04	06H15	05F	40	7
469	FERNWOOD DR	464 WOODLAND DR	427 ASH WAY	1.04	06H15	05F	1040	7
893	FESCUE WAY	894 NIBLICK WAY	892 SAINT ANDREWS DRIVE	0.18	06H25	06F	180	7
784	FIDDLENECK STREET	781 JEWELFLOWER STREET	783 GOLDENSTAR STREET	0.24	06H25	03D	240	7
432	FIFTEENTH ST	354 ARDMORE AVE	357 POWERLINE RD	0.36	06H25	01F	360	7
343	FIFTH AVE	31 OLIVEHURST AVE	352 CANAL ST	0.38	06H15	08F	380	7
10034	FINSBURY WAY	10029 ALDERSGATE DRIVE	S SUBDIVISION BDRY (PLUMAS LAKE PH 8)	0.14				7

**EXHIBIT A
2024 YUBA COUNTY
MAINTAINED ROAD DATA**

ROAD NUMBER	ROAD NAME	FROM - NUMBER AND NAME	TO - NUMBER AND NAME	LENGTH MILES	MAP NUMBER	MAP COORDINATE	MILEAGE FROM TABS	FUNCT. CLASS
442	FIR ROAD	444 CHESTNUT ROAD	483 HICKORY LN	0.28	06H15	07E	280	7
778	FLAMINGO STREET	777 GOLDEN PLOVER STREET	780 SNOWY EGRET STREET	0.12	06H25	03D	120	7
406	FLEDA ST	22 ARBOGA ROAD	317 ALICIA AVE	0.24	06H15	06C	240	7
10001	FLEET COURT	10002 REDFORD WAY	END	0.04				7
355	FLEMING WAY	32 MC GOWAN PKWY	418 FOURTEENTH ST	0.44	06H25	01F	440	7
355	FLEMING WAY	349 ELEVENTH AVE	345 SEVENTH AVE	0.50	06H15	10E	500	7
944	FORBES COURT	933 BALLANTINE WAY	END	0.12	2	09B	180	7
3	FORBESTOWN RD	1 LA PORTE RD	BUT CO	1.00	07G	09K	1000	6
3	FORBESTOWN RD	1 LA PORTE RD	BUT CO	3.50	07G13	07F	3500	6
510	FOREST DR	317 ALICIA AVE	END	0.02	06H15	06C	20	7
134	FORSYTHE RD	135 INDIANA RANCH RD	END	1.63	07G	05E	1630	7
26	FORTY MILE RD	SUT CO	SH065	5.77	06H25	03J	5710	5
26	FORTY MILE RD	SH065	RANCHO RD	0.27	06H25	02K	270	6
130	FOUNTAIN HOUSE RD	135 INDIANA RANCH	END	8.38	07G	05E	8380	7
418	FOURTEENTH ST	31 OLIVEHURST AVE	357 POWERLINE RD	0.48	06H15	10E	480	7
342	FOURTH AVE	352 CANAL ST	END	0.26	06H15	08E	260	7
407	FOURTH ST	302 BROADWAY	END	0.06	06H25	04F	63	7
670	FREEMAN'S COURT	669 BRANDING IRON WAY	END	0.04	06H25	08F	40	7
882	FREESTONE DRIVE	878 AUTUMN LANE	659 RIVERBANK DRIVE	0.18	06H15	06H	180	7
882	FREESTONE DRIVE	659 RIVERBANK DRIVE	920 REDHAVEN STREET	0.22	06H15	06H	220	7
5	FRENCHTOWN RD	8 MARYSVILLE RD	4 WILLOW GLEN RD	7.98	07G	04D	7980	6
201	FRENCHTWN-DOBBINS	133 INDIANA SCH RD	8 MARYSVILLE RD	0.49	1	08E	490	7
201	FRENCHTWN-DOBBINS	5 FRENCHTOWN RD	133 INDIANA SCH RD	1.32	1	08D	1320	7
11	FRUITLAND RD	12 HONCUT RD	8 MARYSVILLE RD	6.25	2	02D	6250	6
11	FRUITLAND RD	12 HONCUT RD	13 RAMIREZ RD	4.05	07G41	05A	10300	7
446	FURNEAUX ROAD	22 ARBOGA ROAD	447 MELODY ROAD	0.58	06H15	08E	580	7
829	GALLANT FOX DRIVE	828 IRISH DRAUGHT WAY	831 GELDERLANDER WAY	0.12	06H25	01E	120	7
315	GARDEN AVE	43 FEATHER RIVER BLVD	310 SYCAMORE AVE	0.51	06H15	06B	510	5
315	GARDEN AVE	310 SYCAMORE AVE	441 RIVERSIDE DR	0.06	06H15	05B	60	7
125	GARDEN VALLEY RD	119 PENDOLA ROAD	END	2.37	07G	03H	2370	7
935	GARLINGTON WAY	867 FEATHER RIDGE DRIVE	930 SUGARSTICK DRIVE	0.07	2	09B	180	7
901	GARNET WAY	899 PEMBROKE DRIVE	898 MINORIES DRIVE	0.04	2	09C	40	7
10016	GATLIN COURT	E SUBDIVISION BOUNDRY (RON 2)	END	0.03	2	09B	180	7
831	GELDERLANDER WAY	22 ARBOGA ROAD	830 CITATION DRIVE	0.14	06H25	01E	140	7
396	GEORGE AVE	395 MARY AVENUE	32 MC GOWAN PKWY	0.82	06H25	02F	820	7
490	GEORGINA DR	489 MEADOW WAY	END	0.10	06H15	10F	100	7
655	GERALD COURT	657 MARYCLAIR DRIVE	END	0.05	06H25	11E	50	7
964	GILA COURT	967 RIO GRANDE DRIVE	END	0.04	2	09B	290	7
904	GLASGLOW DRIVE	845 KIRKHILL DR	849 LOCHCARRON DRIVE	0.18	06H15	06H	10	7
792	GLENHAVEN COURT	787 ATHERTON WAY	END	0.04	2	09B	40	7
459	GLENMORE DR	418 FOURTEENTH ST	418 FOURTEENTH ST	0.21	06H15	10F	210	7
922	GLOWHAVEN STREET	878 AUTUMN LANE	919 NECTAR WAY	0.31	06H15	06H	320	7
922	GLOWHAVEN STREET	S SUBDIVISION BOUNDRY (OP 7)	REDHAVEN STREET	0.10	06H15	06H	90	7
922	GLOWHAVEN STREET	NORTH SUBDIVISION BOUNDARY (SOE)	968 SWAISY DRIVE	0.05				7
532	GOLD LEAF WY	460 EVELYN DR	486 LARSON ST	0.16	06H25	01G	160	7
604	GOLD NUGGET DRIVE	605 CALYPSO RANCH DRIVE	600 ZANES DRIVE	0.15	06H25	08F	150	7
842	GOLD RIVER WAY	659 RIVERBANK DRIVE	840 WATERVILLE DRIVE	0.11	06H15	06G	110	7

**EXHIBIT A
2024 YUBA COUNTY
MAINTAINED ROAD DATA**

ROAD NUMBER	ROAD NAME	FROM - NUMBER AND NAME	TO - NUMBER AND NAME	LENGTH MILES	MAP NUMBER	MAP COORDINATE	MILEAGE FROM TABS	FUNCT. CLASS
10026	GOLD RUSH COURT	765 CIMARRON DRIVE	10018 BOB HAYES DRIVE	0.04				7
453	GOLD STREET	372 PARK AVE	369 GROVE AVE	0.11	06H15	06E	110	7
832	GOLDEN GATE DRIVE	634 OREGON CREEK WAY	631 TABLE MOUNTAIN DRIVE	0.40	06H25	08F	400	7
777	GOLDEN PLOVER STREET	776 SNOW GOOSE STREET	778 FLAMINGO STREET	0.17	06H25	03D	170	7
783	GOLDENSTAR STREET	781 JEWELFLOWER STREET	781 JEWELFLOWER STREET	0.24	06H25	03D	240	7
879	GOLDFIELDS PARKWAY	33 ERLE ROAD	659 RIVERBANK DRIVE	0.27	06H15	06H	270	4
879	GOLDFIELDS PARKWAY	659 RIVERBANK DRIVE	35 NORTH BEALE ROAD	0.85	06H15	06H	850	4
436	GOLF CLUB AVE	435 DIVOT STREET	END	0.14	06H25	06E	140	7
502	GOSSETT WAY	398 SHASTA WAY	END	0.12	06H15	05E	120	7
23	GRAND AVE	43 FEATHER RIVER BLVD	22 ARBOGA ROAD	0.90	06H15	08D	900	5
793	GREENBRAE COURT	787 ATHERTON WAY	END	0.04	2	09B	40	7
608	GREENHORN CREEK CIRCLE	607 BROAD ACRES WAY	607 BROAD ACRES WAY	0.27	06H25	08F	270	7
755	GREENS STREET	756 TWINBERRY STREET	758 PLUMAS LINKS STREET	0.06	06H25	03D	60	7
974	GREYEAGLE COURT	973 SHASTINA WAY	END	0.04	2	09B	180	7
731	GRIEGO AVENUE	733 SHAY AVENUE	726 SUNDARI AVENUE	0.13	06H25	01F	130	7
34	GRIFFITH AVE	END	33 ERLE RD	0.67	06H15	08H	670	7
34	GRIFFITH AVE	36 HMT SMTVLE RD	END	0.41	06H15	04H	410	7
34	GRIFFITH AVE	33 ERLE RD	36 HMT SMTVLE RD	1.69	06H15	07H	1690	5
369	GROVE AVE	36 HMT SMTVLE RD	565 COBBLESTONE DR	0.54	06H15	05E	460	7
683	GUILDFORD WAY	685 CHURCHILL WAY	681 LEIGHTON GROVE DRIVE	0.18	06H25	10E	180	7
815	HABITAT WAY	816 JORDAN DRIVE	818 WALLEN DRIVE	0.11	06H15	04J	110	7
763	HACIENDA DRIVE	606 COFFEE CREEK WAY	711 MORGAN DRIVE	0.14	06H25	08F	140	7
393	HALE RD	338 BERNICE AVE	END	1.02	06H25	01H	1020	7
240	HALLWOOD BLVD	SH020	38 WALNUT AVE	1.07	06G55	06H	1070	6
240	HALLWOOD BLVD	38 WALNUT AVE	END	0.58	06G55	06H	580	7
236	HAMMON GROVE RD	SH020	END	0.20	07G	09B	200	7
37	HAMMONTON RD WEST	SH070	END	0.06	06H15	06C	60	7
37	HAMMONTON RD WEST	21 LINDHURST AVE	SH070	0.23	06H15	06D	230	7
452	HAPPY WAY	36 HMT SMTVLE RD	END	0.10	06H15	04F	100	7
10010	HARCOURT WAY	W SUBDIVISION BOUNDRY (RON 1)	10006 ABROZO WAY	0.03	2	09B	180	7
10010	HARCOURT WAY	929 DUSTY MAIDEN DRIVE	E SUBDIVISION BOUNDRY (RON 2)	0.06	2	09B	180	7
921	HARCREST DR	878 AUTUMN LANE	919 NECTAR WAY	0.32	06H15	06H	320	7
921	HARCREST DRIVE	S SUBDIVISION BOUNDRY (OP 7)	REDHAVEN STREET	0.08	06H15	06H	90	7
161	HARMONY CIR	141 BARTON HILL RD	END	0.09	1	04G	90	7
949	HARVEST STREET	WEST SUBDIVISION BOUNDARY	881 COBBLER LANE	0.07	06H25	06H	70	7
949	HARVEST STREET	887 PEACH TREE DRIVE	947 CANNING WAY	0.09	06H25	06H	90	7
152	HARVEY MINE RD	107 OLD KNOX RD	107 OLD KNOX RD	0.15	07G1	02G	150	7
494	HARVEY RD	395 MARY AVE	396 GEORGE AVE	0.13	06H25	02F	130	7
10008	HASKINS WAY	W SUBDIVISION BOUNDRY (RON 1)	10006 ABROZO WAY	0.07	2	09B	180	7
10008	HASKINS WAY	929 DUSTY MAIDEN DRIVE	E SUBDIVISION BOUNDRY (RON 2)	0.06	2	09B	180	7
694	HASTINGS COURT	683 GUILDFORD WAY	END	0.03	06H25	10E	30	7
428	HAZEL ST	323 ELLA AVE	END	0.24	06H25	02D	240	7
909	HEARTLAND DR	44 RIVER OAKS BLVD	853 BROKEN BIT DR	0.44	06H25	10F	440	7
439	HEDGE AVE	388 LAUREL AVE	END	0.21	06H15	06B	210	7
952	HENNESSEY WAY	867 FEATHER RIDGE DRIVE	951 BERRYESSA WAY	0.03	06H35	04G	30	7
483	HICKORY LANE	481 CATALPA ST	442 FIR RD	0.27	06H15	07E	270	7
734	HICKS AVENUE	733 SHAY AVENUE	726 SUNDARI AVENUE	0.17	06H25	01F	170	7

**EXHIBIT A
2024 YUBA COUNTY
MAINTAINED ROAD DATA**

ROAD NUMBER	ROAD NAME	FROM - NUMBER AND NAME	TO - NUMBER AND NAME	LENGTH MILES	MAP NUMBER	MAP COORDINATE	MILEAGE FROM TABS	FUNCT. CLASS
615	HIDDEN CREEK WAY	641 KNIGHTS FERRY DRIVE	44 RIVER OAKS BLVD	0.31	06H25	08F	200	7
673	HIGH NOON DRIVE	675 LONG HORN TRAIL DR	675 LONG HORN TRAIL DR	0.65	06H25	08F	260	7
361	HILE AVE	36 HMT SMTSVLE RD	402 MC LAUGHLIN WY	0.40	06H15	04E	400	7
264	HILL RD	10 LOMA RICA RD	END	1.21	07G41	04F	1210	7
36	HMT SMARTSVILLE RD	SH020	907 CHUCK YEAGER RD	1.01	07G	10D	1010	5
36	HMT SMARTSVILLE RD	907 CHUCK YEAGER RD	URBAN LIMIT	13.26	07G53	07A	13260	5
36	HMT SMARTSVILLE RD	35 N BEALE ROAD	387 DANTONI RD	1.60	06H15	04G	1600	4
36	HMT SMARTSVILLE RD	URBAN LIMIT	387 DANTONI RD	0.50	06H15	04G	2100	5
36	HMT SMARTSVILLE RD	35 N BEALE RD	364 RUPERT RD	0.55	06H15	05E	550	5
36	HMT SMARTSVILLE RD	364 RUPERT RD	END	0.08	06H15	05D	80	7
326	HOFFMAN PLUMAS RD	26 FORTY MILE RD	417 HOFFMAN RD	0.90	06H25	07J	900	7
998	HOGAN WAY	995 PALMER DRIVE	999 MICKELSON DRIVE	0.19				7
392	HOLLY AVE	391 N GLEDHILL AVE	END	0.10	06H15	06C	100	7
178	HOLMES WAY	4 WILLOW GLEN RD	END	0.16	1	06D	156	7
12	HONCUT RD	11 FRUITLAND RD	BUT CO	0.60	07G41	01D	600	6
636	HONEY RUN COURT	635 BIDWELL BAR DRIVE	END	0.06	06H25	08F	60	7
239	HOOPER RD	END	END	0.61	06G55	06J	610	7
258	HOOVER RD	10 LOMA RICA RD	END	0.25	07G41	03H	250	7
820	HORMAN DRIVE	816 JORDAN DRIVE	818 WALLEN DRIVE	0.15	06H15	04J	150	7
629	HOT SPRINGS COURT	569 SHORELINE DRIVE	END	0.02	06H15	06E	20	7
610	HUMBUG COURT	588 SOLDIERS RANCH WAY	END	0.03	06H25	08F	30	7
742	HUNTER'S CREEK STREET	855 LINKS PARKWAY	746 DEERWOOD STREET	0.03	06H25	03D	30	7
875	HUSTON WAY	SW SUBDIVISION BOUNDRY	874 LARNER WAY	0.15	06H25	02E	150	7
579	HUTTON COURT	360 LINDA AVENUE	END	0.05	06H15	04F	50	7
865	IBERIAN COURT	867 FEATHER RIDGE DRIVE	END	0.11	2	09B	110	7
924	IBUS COURT	498 ARCANO AVENUE	END	0.04	06H25	02F	40	7
174	IDLEWOOD CIR	103 NEW YORK FLAT RD	103 NEW YORK FLAT RD	0.77	07G13	10C	767	7
592	INDEPENDENCE TRAIL	44 RIVER OAKS BLVD	45 PLUMAS LAKE BLVD	0.70	06H25	08F	700	7
785	INDIAN CLOVER STREET	781 JEWELFLOWER STREET	784 FIDDLENECK STREET	0.10	06H25	03D	100	7
176	INDIAN ROCK CT	174 IDLEWOOD CIR	END	0.05	07G13	10B	49	7
135	INDIANA RANCH RD	8 MARYSVILLE RD	129 OREGON HILL	0.20	07G	05E	200	7
135	INDIANA RANCH RD	8 MARYSVILLE RD	129 OREGON HILL	7.48	07G	05E	7480	7
133	INDIANA SCHOOL RD	8 MARYSVILLE RD	135 INDIANA RANCH RD	2.75	07G	06E	2750	7
136	INDIANA-NEW YORK RD	135 INDIANA RANCH RD	137 NEW YORK HOUSE RD	0.80	1	06E	800	7
136	INDIANA-NEW YORK RD	135 INDIANA RANCH RD	137 NEW YORK HOUSE RD	0.38	1	06E	380	7
450	INEZ WAY	449 TYLER AVE	448 BEEDE AVE	0.09	06H15	04E	90	7
852	INVERNESS COURT	849 LOCHCARRON DRIVE	END	0.02	06H15	05H	20	7
212	IOWA CITY RD	10 LOMA RICA RD	11 FRUITLAND RD	1.59	07G41	06C	1590	7
828	IRISH DRAUGHT WAY	654 EUGENE DRIVE	830 CITATION DRIVE	0.11	06H25	01E	110	7
752	IRONWOOD STREET	751 WATER LEAF STREET	753 SUTTER TRAILS STREET	0.11	06H25	03D	110	7
320	ISLAND AVE	END	23 GRAND AVE	0.21	06H15	07B	210	7
697	ISLESWORTH WAY	688 ARLINGTON WAY	END	0.16	06H25	10E	160	7
697	ISLESWORTH WAY	N SUBDIVISION BDRY (PLUMAS LAKE PH 7)	982 BOSWELL WAY	0.13				7
915	IVY HATCH WAY	903 TUDOR WAY	N SUBDIVISION BOUNDRY	0.23	06H35	02F	230	7
915	IVY HATCH WAY	SW SUBDIVISION BDRY (PLUMAS LAKE PH 6)	979 CROWDER WAY	0.12				7
15	JACK SLOUGH RD	MVL	14 WOODRUFF LANE	3.76	06H15	01D	3760	5
144	JACKSON ST	SH049	147 SPRING ST	0.24	07G1	03A	240	7

**EXHIBIT A
2024 YUBA COUNTY
MAINTAINED ROAD DATA**

ROAD NUMBER	ROAD NAME	FROM - NUMBER AND NAME	TO - NUMBER AND NAME	LENGTH .MILES	MAP NUMBER	MAP COORDINATE	MILEAGE FROM TABS	FUNCT. CLASS
637	JACOBY CREEK COURT	635 BIDWELL BAR DRIVE	END	0.08	06H25	08F	80	7
934	JADESTON WAY	933 BALLANTINE WAY	930 SUGARSTICK DRIVE	0.13	2	09B	180	7
972	JAMISON CREEK WAY	866 CHALICE CREEK DRIVE	973 SHASTINA WAY	0.37	2	09B	180	7
817	JANA WAY	816 JORDAN DRIVE	818 WALLEN DRIVE	0.11	06H15	04J	110	7
390	JANET AVE	22 ARBOGA ROAD	END	0.06	06H15	06D	60	7
978	JARDINE COURT	979 CROWDER WAY	END	0.07				7
526	JASON DR	525 SILVERWOOD ST	END	0.23	06H15	05D	230	7
331	JASPER LANE	334 OSTROM ROAD	40 SPENCEVILLE RD	3.70	2	07D	3700	7
438	JAY ST	22 ARBOGA ROAD	317 ALICIA AVE	0.24	06H15	06C	240	7
180	JAYNES LN	8 MARYSVILLE RD	179 OLD MARYSVILLE R	0.04	1	06H	40	7
463	JEFFERY CT	461 TWAIN DRIVE	END	0.09	06H25	01G	90	7
953	JEWEL LAKE WAY	866 CHALICE CREEK DRIVE	867 FEATHER RIDGE DRIVE	0.23	06H35	04G	230	7
781	JEWELFLOWER STREET	783 GOLDENSTAR STREET	783 GOLDENSTAR STREET	0.52	06H25	03D	520	7
426	JEWETT AVE	END	376 BROPHY ROAD	0.48	2	06C	480	7
166	JIGGS RD	164 PONDEROSA WY	END	0.28	07G	03D	280	7
819	JILLIAN DRIVE	816 JORDAN DRIVE	818 WALLEN DRIVE	0.14	06H15	04J	140	7
10017	JIM HINES DRIVE	W SUBDIVISION BOUNDRY (DRN 2)	876 PITTENGER DRIVE	0.11	06H25	02E	60	7
217	JOINES RD	SH020	216 SPRING VALLEY RD	0.84	07G	09B	840	7
591	JONES BAR COURT	590 JONES BAR TRAIL	END	0.04	06H25	08F	40	7
590	JONES BAR TRAIL	589 SECRET LAKE TRAIL	592 INDEPENDENCE TRAIL	0.19	06H25	08F	190	7
816	JORDAN DRIVE	36 HAMMONTON-SMARTVILLE ROAD	815 HABITAT WAY	0.23	06H15	04J	230	7
153	JOY CIRCLE	1 LA PORTE RD	END	0.36	07G1	02H	360	7
274	JUDY ST	271 VICKIE DR	END	0.18	07G41	05F	180	7
678	JUNE WAY	677 SUMMERFIELD LANE	676 AUGUST WAY	0.06	06H25	11G	60	7
535	KAREN WAY	442 FIR RD	444 CHESTNUT RD	0.19	06H15	07D	186	7
727	KARTIKEYA AVENUE	724 SEYKOTA AVENUE	726 SUNDARI AVENUE	0.12	06H25	01F	120	7
823	KATRINA DRIVE	573 RICK DRIVE	N SUBDIVISION BOUNDRY	0.08	06H15	04H	80	7
823	KATRINA DRIVE	999 MICKELSON DRIVE	SUBDIVISION BDRY (DANTONI RANCH ESTATES # 1)	0.11				7
400	KAY ST	22 ARBOGA ROAD	317 ALICIA AVE	0.24	06H15	06C	240	7
157	KELLY RD	8 MARYSVILLE RD	7 MOONSHINE RD	1.60	07G	04H	1600	7
682	KENSINGTON DRIVE	44 RIVER OAKS BLVD	END	0.24	06K25	10E	240	7
682	KENSINGTON DRIVE	S SUBDIVISION BDRY (PLUMAS LAKE PH 7)	NW SUBDIVISION BDRY (PLUMAS LAKE PH 7)	0.26				7
888	KENT WAY	S SUBDIVISION BOUNDRY	END	0.08	06H15	06f	80	7
471	KENWOOD WAY	469 FERNWOOD DR	469 FERNWOOD DR	0.31	06H15	05E	310	7
925	KESTREL COURT	814 PURPLE MARTIN ROAD	END	0.03	06H25	02F	30	7
224	KIBBE RD	LOMA RICA RD	10 SH020	2.02	06G55	04J	2020	7
905	KILBIRNIE WAY	848 TURNBERRY DRIVE	849 LOCHCARRON DRIVE	0.01	06H15	06H	10	7
237	KIMBALL LANE	14 WOODRUFF LANE	15 JACK SLOUGH RD	3.27	06G55	05G	3270	7
279	KIMBERLY RD	10 LOMA RICA RD	283 DAWN DR	1.87	07G	07B	1870	7
509	KIMERER DR	317 ALICIA AVE	END	0.02	06H15	06C	20	7
10035	KINGS COURT	681 LEIGHTON GROVE DRIVE	END	0.07				7
846	KIRKHILL DRIVE	847 STONEHAVEN DR	847 STONEHAVEN DR	0.46	06H15	05H	190	7
957	KIRKWOOD COURT	954 ENGLEBRIGHT WAY	END	0.06	06H35	04G	60	7
598	KNEEBONE COURT	592 INDEPENDENCE TRAIL	END	0.04	06H25	08F	40	7
641	KNIGHTS FERRY DRIVE	640 FELTON WAY	909 HEARTLAND DR	0.73	06H25	08E	130	7
969	KNOTTY PINE WAY	866 CHALICE CREEK DRIVE	951 BERRYESSA WAY	0.18	2	09B	180	7
208	KROSENS RD	206 LOOP ROAD	END	0.89	07G41	02H	890	7

**EXHIBIT A
2024 YUBA COUNTY
MAINTAINED ROAD DATA**

ROAD NUMBER	ROAD NAME	FROM - NUMBER AND NAME	TO - NUMBER AND NAME	LENGTH MILES	MAP NUMBER	MAP COORDINATE	MILEAGE FROM TABS	FUNCT. CLASS
813	KYRI COURT	812 PARTRIDGE PARKWAY	END	0.02	625	03E	20	7
1	LA PORTE RD	141 BARTON HILL RD	PLU CO LINE	5.39	1	03G	5390	5
1	LA PORTE RD	141 BARTON HILL RD	141 BARTON HILL RD	1.14	1	04G	1140	7
1	LA PORTE RD	PLU NF BDRY/BUT CO LINE	141 BARTON HILL RD	0.67	1	04F	6790	5
1	LA PORTE RD	4 WILLOW GLEN RD	BUT CO	8.35	1	06D	8350	5
1	LA PORTE RD	BUT CO	4 WILLOW GLEN RD	4.31	1	06C	4310	5
1	LA PORTE RD	BUT CO LINE	PLU NF BDRY BUT CO L	2.50	07G	04F	2500	5
740	LADY FERN STREET	735 YARROW STREET	739 VELVET LEAF STREET	0.23	06H25	03D	230	7
531	LAGO RD	UBRAN LIMIT	END	0.17	06H15	05H	165	7
531	LAGO RD	34 GRIFFITH AVE	URBAN LIMIT	0.08	06H15	05H	55	7
102	LAGUE RD	1 LA PORTE RD	END	1.85	07G	04D	1850	7
139	LAKE FRANCIS RD	8 MARYSVILLE RD	1051	2.78	07G	06F	2760	7
648	LAKEPORT WAY	652 LOCKWOOD DRIVE	647 PRESIDIO WAY	0.20	06H25	08E	201	7
961	LAKESHORE COURT	967 RIO GRANDE DRIVE	END	0.05	2	09B	290	7
209	LAMBERT	206 LOOP ROAD	END	0.30	07G41	02H	300	7
557	LARIAT LN	543 DONALD DR	541 DEATON DR	0.15	06H25	01F	150	7
874	LARNER WAY	323 ELLA AVENUE	END	0.13	06H25	02E	130	7
542	LARRY ST	541 DEATON DR	543 DONALD DR	0.17	06H25	01F	166	7
486	LARSON ST	485 LEVER AVE	32 MC GOWAN PKWY	0.18	06H25	01G	180	7
388	LAUREL AVE	END	22 ARBOGA ROAD	0.38	06H15	06C	380	7
214	LAUREL LANE	215 OLD HIGHWAY	END	0.83	06G	07H	830	7
431	LAUREL WAY	323 ELLA AVENUE	END	0.10	06H25	02D	100	7
233	LAURELLEN RD	SH070	END	1.11	06G55	09A	1110	7
941	LAVENDER COURT	934 JADESTON WAY	END	0.05	2	09B	180	7
327	LEACH ROAD	END	26 FORTY MILE RD	2.22	06H	05J	2220	7
681	LEIGHTON GROVE DRIVE	44 RIVER OAKS BLVD	687 NOTTING HILL WAY	0.36	06H25	10E	360	7
681	LEIGHTON GROVE DRIVE	10036 LONDON WAY	E SUBDIVISION BDRY (RIVER OAKS BLVD)	0.09				7
440	LEON AVE	36 HMT SMTVLE RD	434 SCALES ST	0.07	06H15	06D	70	7
485	LEVER AVE	END	461 TWAIN DR	0.63	06H25	01G	630	7
328	LEWIS RD	330 DRY CRK LEVEE	28 WHEATLAND RD	1.15	2	08D	1150	7
250	LINCOLN AVE	224 KIBBE ROAD	END	0.25	07G	09A	810	7
360	LINDA AVE	36 HMT SMTVLE RD	35 N BEALE ROAD	0.72	06H15	05E	720	5
360	LINDA AVE	879 GOLDFIELDS PARKWAY	34 GRIFFITH AVE	0.68	06H15	05G	950	7
613	LINDENMEIR DRIVE	45 PLUMAS LAKE BLVD	611 CASA DULCE WAY	0.22	06H25	08F	220	7
21	LINDHURST AVE	35 N BEALE RD	SH070	1.94	06H15	05C	1940	5
855	LINKS PARKWAY	25 PLUMAS ARBOGA ROAD	END	0.50	06H25	03D	500	7
527	LISA WY	526 JASON DR	END	0.37	06H15	05D	370	7
256	LITTLEFIELD RD	11 FRUITLAND RD	END	0.57	07G41	01F	570	7
507	LOBATA RD	219 BALD MT RD	END	0.17	07G	07C	170	7
849	LOCHCARRON DRIVE	850 WESTHILL DRIVE	N SUBDIVISION BOUNDRY	0.22	06H15	05H	220	7
849	LOCHCARRON DRIVE	N SUBDIVISION BOUNDRY	904 GLASGLOW DRIVE	0.02	06H15	05H	18	7
849	LOCHCARRON DRIVE	904 GLASGLOW DRIVE	689 TURNBERRY DRIVE	0.12	06H15	05H	124	7
652	LOCKWOOD DRIVE	648 LAKEPORT WAY	44 RIVER OAKS BLVD	0.13	2	09B	130	7
10	LOMA RICA RD	SH020	8 MARYSVILLE RD	14.57	06G55	04J	14600	5
10036	LONDON WAY	10029 ALDERSGATE DRIVE	10033 CAMOMILE DRIVE	0.11				7
675	LONG HORN TRAIL DRIVE	673 HIGH NOON DR	909 HEARTLAND DR	0.39	06H25	08F	110	7
41	LONG RAVINE RD	42 CAMP FAR WEST	40 SPENCEVILLE RD	1.70	2	06G	1700	6

**EXHIBIT A
2024 YUBA COUNTY
MAINTAINED ROAD DATA**

ROAD NUMBER	ROAD NAME	FROM - NUMBER AND NAME	TO - NUMBER AND NAME	LENGTH MILES	MAP NUMBER	MAP COORDINATE	MILEAGE FROM TABS	FUNCT. CLASS
206	LOOP RD	10 LOMA RICA RD	11 FRUITLAND RD	1.39	07G41	03J	1390	7
990	LOS ALTOS COURT	787 ATHERTON WAY	END	0.05				7
204	LOS VERJELES RD	10 LOMA RICA RD	BUT CO	2.56	07G	07C	2560	5
111	LOST CR DAM RD	1 LA PORTE RD	BUT CO	0.58	1	04G	580	7
703	LOST CREEK RANCH DRIVE	600 ZANES DRIVE	END	0.20	06H25	08F	200	7
759	LOST TRAIL DRIVE	606 COFFEE CREEK WAY	761 DRY GULTCH TRAIL DRIVE	0.27	06H25	08F	270	7
861	LOTHLAND COURT	857 CALABRESE WAY	END	0.04	2	09B	40	7
511	LOWE AVE	36 HMT SMTVLE RD	35 N BEALE RD	0.20	06H15	05D	200	7
650	LUCERN COURT	648 LAKEPORT WAY	END	0.06	2	09B	60	7
10023	MADISON COURT	N SUBDIVISION BDRY (RMV 4 / CIMARRON DRIVE)	END	0.11				7
337	MAGE AVE	336 ROSE AVENUE	END	0.34	06H25	01H	340	7
10014	MAGGIE COURT	929 DUSTY MAIDEN DRIVE	END	0.06	2	09B	180	7
227	MAGNOLIA RD	SH070	END	1.03	06G55	02A	1030	7
248	MAGONIGAL LN	36 HAMMONTON-SMRTSVLL RD	END	0.19	2	09J	190	7
896	MANCHESTER DRIVE	895 NEWCASTLE WAY	REMINGTON WAY	0.06	06H15	06G	60	7
278	MANZANITA LN	202 RICES XING RD	END	0.11	07G	06E	110	7
363	MAPES WAY	END	361 HILE AVE	0.09	06H15	05E	90	7
363	MAPES WAY	361 HILE AVE	36 HMT SMTVLE RD	0.17	06H15	04F	170	7
496	MAPLEHURST ST	22 ARBOGA RD	499 BIGLOW DR	0.44	06H25	02E	440	7
646	MARIN COURT	644 TIBURON WAY	END	0.05	2	09B	50	7
577	MARSH DR	576 RIVER RUN DR	578 SHALLOW CR	0.12	06H15	06F	116	7
488	MARTEL DR	460 EVELYN DR	414 OLIVE AVE	0.46	06H25	01G	460	7
140	MARTIN ROAD	1 LA PORTE RD	END	0.83	07G	04C	830	7
395	MARY AVE	32 MC GOWAN PKWY	396 GEORGE AVE	0.67	06H25	01F	670	7
657	MARYCLAIR DRIVE	22 ARBOGA ROAD	END	0.24	06H25	11E	240	7
656	MARYPAT DRIVE	657 MARYCLAIR DRIVE	496 MAPLEHURST ST	0.06	06H25	11E	60	7
8	MARYSVILLE RD	SH020	4 WILLOW GLEN RD	11.32	07G	09B	11320	4
8	MARYSVILLE RD	4 WILLOW GLEN RD	129 OREGON HILL RD	11.57	07G	06D	12930	4
8	MARYSVILLE RD	129 OREGON HILL RD	SH049	7.93	07G	06G	7000	4
226	MATHEWS LANE	14 WOODRUFF LANE	13 RAMIREZ ROAD	3.59	06G55	05F	3590	5
956	MATTOLE COURT	957 KIRKWOOD COURT	END	0.06	06H35	04G	60	7
667	MAVERICK DRIVE	673 HIGHNOON DRIVE	631 TABLE MOUNTAIN DRIVE	0.28	06H25	08F	280	7
265	MAYER RD	SH070	241 SADDLEBACK DR	0.20	06G55	08A	200	7
480	MAYWOOD CT	469 FERNWOOD DR	END	0.03	06H15	06E	30	7
516	MAYWOOD DR	369 GROVE AVE	469 FERNWOOD DR	0.19	06H15	05E	190	7
872	MCALISTER COURT	873 DUNWOODY DRIVE	END	0.12	06H25	02E	120	7
619	MCCARTHY AVENUE	617 ANGELICA WAY	621 BLUEBELL AVE	0.09	06H25	01F	90	7
32	MCGOWAN PARKWY	22 ARBOGA ROAD	SH070	1.06	06H25	01E	1060	4
32	MCGOWAN PARKWY	SH070	SH065	0.72	06H25	01H	720	4
32	MCGOWAN PARKWY	SH065	20 RANCHO RD	0.19	06H25	01H	190	5
124	MCLAIN RD	125 GARDEN VLY RD	END	3.52	07G	03H	3520	7
402	MCLAUGHLIN WAY	36 HMT SMTVLE RD	361 HILE AVE	0.17	06H15	04F	170	7
824	MEADOW BROOK WAY	844 RIVER WOOD DRUVE	843 MOSS GLEN LOOP	0.45	06H15	06G	400	7
518	MEADOW CT	489 MEADOW WAY	END	0.08	06H15	10F	80	7
743	MEADOW RANCH STREET	742 HUNTER'S CREEK STREET	744 MORNING GLORY STREET	0.28	06H25	03D	280	7
504	MEADOW VALLEY RD	138 TEXAS HILL RD	END	0.57	1	08E	570	7
489	MEADOW WAY	458 BOMANN DR	349 ELEVENTH AVE	0.28	06H15	10F	280	7

**EXHIBIT A
2024 YUBA COUNTY
MAINTAINED ROAD DATA**

ROAD NUMBER	ROAD NAME	FROM - NUMBER AND NAME	TO - NUMBER AND NAME	LENGTH MILES	MAP NUMBER	MAP COORDINATE	MILEAGE FROM TABS	FUNCT. CLASS
821	MELISSA COURT	820 HORMAN DRIVE	END	0.03	06H15	04J	30	7
447	MELODY ROAD	22 ARBOGA ROAD	446 FURNEAUX RD	0.77	06H15	08E	770	7
946	MERICREST WAY	948 WOODLET STREET	949 HARVEST STREET	0.05	06H25	06H	50	7
156	MERRIAM RD	8 MARYSVILLE RD	END	0.60	1	08E	600	7
999	MICKELSON DRIVE	387 DANTONI ROAD	W SUBDIVISION BDRY (N DANTONI RANCH)	0.25				7
160	MILL RD	120 PENDOLA EXT	END	0.58	1	05H	580	7
148	MILL ST	146 CLEVELAND AVE	144 JACKSON ST	0.56	07G1	04B	560	7
838	MILLFRONT COURT	825 STONEY CREEK WAY	END	0.04	06H15	06G	40	7
630	MINERAL SPRINGS COURT	565 COBBLESTONE DR	END	0.05	06H15	06E	50	7
898	MINORIES DRIVE	899 PEMBROKE DRIVE	E SUBDIVISION BOUNDRY	0.23	2	09C	240	7
898	MINORIES DRIVE	44 RIVER OAKS BLVD	NE SUBDIVISION BOUNDRY	0.02	2	09C	20	7
898	MINORIES DRIVE	S SUBDIVISION BDRY (PLUMAS LAKE 2B-2A)	N SUBDIVISION BDRY (PM2004-09)	0.24				7
898	MINORIES DRIVE	NW SUBDIVISION BDRY (PLUMAS LAKE PH 5)	SE SUBDIVISION BDRY (PLUMAS LAKE PH 5)	0.25				7
803	MISSION COURT	468 WILDWOOD DRIVE	END	0.07	06H15	06G	70	7
617	MISSOURI BAR COURT	592 INDEPENDENCE TRAIL	END	0.06	06H25	08F	60	7
596	MISSOURI BAR TRAIL	592 INDEPENDENCE TRAIL	44 RIVER OAKS BLVD	0.07	06H25	08F	70	7
10004	MITRE COURT	898 MINORIES DRIVE (PLUMAS LAKE PH 4)	END	0.05				7
368	MONTCLAIR AVE	36 HMT SMTVLE RD	END	0.30	06H15	05D	300	7
839	MONTEAGLE COURT	930 SUGARSTICK DRIVE	END	0.11	2	09B	180	7
800	MONTEREY WAY	797 SANTA CRUZ DRIVE	END	0.30	2	09B	300	7
378	MOON AVE	379 SUN AVENUE	35 N BEALE ROAD	0.34	2	06C	340	7
7	MOONSHINE RD	8 MARYSVILLE RD	SH049	5.12	1	07G	5120	7
163	MORAN RD	129 OREGON HILL	END	1.16	07G	04F	1160	7
711	MORGAN DRIVE	761 DRY GULCH TRAIL DRIVE	END	0.35	06H25	08F	210	7
744	MORNING GLORY STREET	743 MEADOW RANCH STREET	736 BAMBOO STREET	0.11	06H25	03D	110	7
422	MORRISON RD	SH065	END	0.39	2	08C	390	7
843	MOSS GLEN LOOP	824 MEADOW BROOK WAY	824 MEADOW BROOK	0.40	06H15	06G	400	7
115	MT HOUSE RD	146 CLEVELAND AVE	SIE CO	1.56	07G1	03B	1560	7
609	MUIR RANCH COURT	588 SOLDIERS RANCH WAY	END	0.08	06H25	08F	80	7
154	MULOCK RD	1 LA PORTE RD	END	0.09	07G1	02H	90	7
403	MURPHY RD	43 FEATHER RIVER BLVD	END	0.44	06H25	01D	900	7
257	MUSHOLT RD	260 YUBA NEVADA RD	138 TEXAS HILL RD	0.40	07G	06E	400	7
705	MUSTANG COURT	606 COFFEE CREEK WAY	END	0.03	06H25	08F	30	7
306	MYRNA AVE	43 FEATHER RIVER RD	END	0.22	06H15	08C	220	7
955	NAVARRO COURT	952 HENNESSEY WAY	END	0.04	06H35	04G	40	7
391	N GLEDHILL AVE	23 GRAND AVE	388 LAUREL AVE	0.18	06H15	06C	180	7
919	NECTAR WAY	882 FREESTONE DRIVE	883 SEEDLING WAY	0.02	06H15	06H	20	7
919	NECTAR WAY	883 SEEDLING WAY	922 GLOWHAVEN STREET	0.14	06H15	06H	140	7
919	NECTAR WAY	W SUBDIVISION BOUNDRY (OP 7)	END	0.07	06H15	06H	90	7
275	NEIL DR	271 VICKIE DR	END	0.06	07G41	05F	60	7
131	NERO RD	1 LA PORTE RD	END	0.51	07G	03E	510	7
103	NEW YORK FLAT RD	BUT CO	1 LA PORTE RD	3.40	07G	03E	3400	7
137	NEW YORK HOUSE RD	5 FRENCHTOWN RD	1 LA PORTE RD	4.22	07G	04E	4220	7
895	NEWCASTLE WAY	659 RIVERBANK DRIVE	MANCHESTER DRIVE	0.06	06H15	06G	60	7
945	NEWPORT COURT	933 BALLANTINE WAY	END	0.12	2	09B	180	7
663	NIAGARA CREEK WAY	580 WATERFALL DRIVE	659 RIVER BANK DRIVE	0.11	06H15	06E	110	7
894	NIBLICK WAY	44 RIVER OAKS BLVD	892 SAINT ANDREWS DRIVE	0.03	06H25	06F	30	7

**EXHIBIT A
2024 YUBA COUNTY
MAINTAINED ROAD DATA**

ROAD NUMBER	ROAD NAME	FROM - NUMBER AND NAME	TO - NUMBER AND NAME	LENGTH MILES	MAP NUMBER	MAP COORDINATE	MILEAGE FROM TABS	FUNCT. CLASS
998	NICKLAUS DRIVE	999 MICKELSON DRIVE	996 HOGAN WAY	0.25				7
779	NIGHT HERON STREET	855 LINKS PARKWAY	778 FLAMINGO STREET	0.19	06H25	03D	190	7
347	NINTH AVE	357 POWERLINE RD	END	0.80	06H15	09F	800	7
347	NINTH AVE	22 ARBOGA ROAD	353 PACIFIC AVE	0.12	06H15	09D	120	7
35	NO BEALE RD	URL .26M E/GRIFFITH AVE	1.8 W/MAIN GATE BEALE AFB	2.38	2	06C	2380	4
35	NO BEALE RD	1.8 W/MAIN GATE BEALE AFB	URL .35M W/MAIN GATE BEALE AFB	1.65	2	05H	1650	5
35	NO BEALE RD	SH070	URBAN LIMIT	3.63	06H15	05B	3650	4
35	NO BEALE RD	.35M W/MAIN GATE BEALE AFB	1016 BEALE AFB BDRY	0.35	06H15	05H	350	5
230	NOBLE RD	SH070	END	0.69	06G55	04A	690	7
877	NORBY COURT	874 LARNER WAY	END	0.13	06H25	02E	130	7
254	NORTH AVE	11 FRUITLAND RD	255 SUMMIT AVE	0.11	07G4	03H	110	7
717	NORTH FORK WAY	566 EDGEWATER CIR	715 PYRAMID CREEK DRIVE	0.13	06H15	06F	130	7
170	NORTH LOOP RD	1 LA PORTE ROAD	155 TAYLOR WAY	0.05	07G1	02G	50	7
266	NORTH ROBERTA WAY	234 DOC ADAMS RD	END	0.11	06H15	01A	110	7
687	NOTTING HILL WAY	689 TURNBRIDGE WAY	684 PADDINGTON WAY	0.28	06H25	10E	280	7
687	NOTTING HILL WAY	982 BOSWELL WAY	698 STEPNEY WAY	0.05				7
900	NYE COURT	898 MINORIES DRIVE	END	0.01	2	09C	10	7
889	OAK PARK DRIVE	372 PARK AVENUE	369 GROVE AVENUE	0.13	06H15	06F	130	7
112	OAK VALLEY RD	113 OLD OAK VLY RD	SH049	0.29	1	05H	290	7
29	OAKLEY LANE	28 WHEATLAND RD	SH065	2.48	2	09D	2840	7
467	OAKWOOD DR	566 EDGEWATER CIR	465 PARK CIR	0.44	06H15	06E	438	7
245	O'BRIEN RD	19 SMARTVILLE RD	19 SMARTVILLE RD	0.20	07G53	05A	200	7
722	OCEAN PARK COURT	721 BAYWOOD DRIVE	END	0.06	06H15	06F	60	7
10025	OHIO COURT	967 RIO GRANDE DRIVE	END	0.04				7
412	OKMULGEE AVE	END	END	0.18	06H15	09E	180	7
117	OLD CAMPTONVILLE RD	179 OLD MARYSVILLE RD	TAHOE NF BDRY	1.50	07G	04H	1500	7
117	OLD CAMPTONVILLE RD	TAHOE NF BDRY	SH049	0.85	07G	04H	850	7
117	OLD CAMPTONVILLE RD	8 MARYSVILLE RD	179 OLD MARYSVILLE RD	0.03	07G	04H	30	7
105	OLD CHALLENGE RD	3 FORBESTOWN RD	1 LA PORTE RD	0.47	07G1	02E	470	7
290	OLD DOBBINS ROAD	8 MARYSVILLE RD	8 MARYSVILLE RD	0.99	07G	08E	990	7
430	OLD FORTY MILE RD	430 OLD FORTY MILE RD	26 FORTY MILE RD	0.46	06H25	07K	460	7
914	OLD HIGHWAY 20	STATE HIGHWAY 20	STATE HIGHWAY 20	0.67	07G	09D	670	7
643	OLD INDIANA RANCH ROAD	135 INDIANA RANCH RD	135 INDIANA RANCH RD	1.05	07G	06E	1050	7
107	OLD KNOX RD	1 LA PORTE RD	105 OLD CHLNG RD	2.22	07G1	02G	2220	7
107	OLD KNOX RD	1 LA PORTE ROAD	105 OLD CHLNG RD	0.35	07G1	02G	350	7
109	OLD LA PORTE RD	PLU NF BDRY	1 LA PORTE RD	0.21	07G1	02H	210	7
109	OLD LA PORTE RD	1 LA PORTE RD	PLU NF BDRY	0.20	07G1	02H	200	7
179	OLD MARYSVILLE RD	180 JAYNES LN	END	0.45	1	06H	610	7
408	OLD MARYSVILLE RD	25 PLUMAS ARBOGA RD	END	0.50	06H25	07G	500	7
113	OLD OAK VALLEY RD	SIE CO	112 OAK VALLEY RD	0.20	1	05H	200	7
142	OLD S H ALIGN	SH049	SIE CO	0.14	1	05H	140	7
215	OLD STATE HIGHWAY	SH070	END	0.39	06G	07H	390	7
121	OLD TOLL RD	8 MARYSVILLE RD	7 MOONSHINE RD	4.32	07G	04H	4320	7
680	OLEANER LANE	380 DUNNING AVE	360 LINDA AVE	0.14	06H15	05F	140	7
414	OLIVE AVE	32 MC GOWAN PKWY	END	0.67	06H25	01G	670	7
521	OLIVE CT	414 OLIVE AVE	END	0.04	06H15	10G	40	7
31	OLIVEHURST AVE	21 LINDHURST AVE	32 MC GOWAN PKWY	1.85	06H15	08E	1850	4

**EXHIBIT A
2024 YUBA COUNTY
MAINTAINED ROAD DATA**

ROAD NUMBER	ROAD NAME	FROM - NUMBER AND NAME	TO - NUMBER AND NAME	LENGTH MILES	MAP NUMBER	MAP COORDINATE	MILEAGE FROM TABS	FUNCT. CLASS
634	OREGON CREEK WAY	632 GOLDEN GATE DRIVE	END	0.10	06H25	08F	100	7
129	OREGON HILL RD	8 MARYSVILLE RD	163 MORAN ROAD	7.22	07G	05F	6780	6
129	OREGON HILL RD	163 MORAN ROAD	1 LA PORTE RD	4.56	07G	05F	5000	6
645	ORICK WAY	44 RIVER OAKS BLVD	END	0.06	2	09B	60	7
651	ORINDA COURT	644 TIBURON WAY	END	0.03	2	09B	30	7
334	OSTROM RD	20 RANCHO RD	1014	7.22	06H25	02K	7490	7
810	OWL NEST DRIVE	806 PHEASANT RUN DRIVE	END	0.04	625	03E	40	7
762	OXBOW COURT	761 DRY GULCH TRAIL DRIVE	END	0.05	06H25	08F	50	7
690	OXFORD COURT	681 LEIGHTON GROVE DRIVE	END	0.04	06H25	10E	40	7
353	PACIFIC AVE	349 ELEVENTH AVE	345 SEVENTH AVE	0.50	06H15	10E	500	7
989	PACIFIC GROVE WAY	787 ATHERTON / 922 LOS ALTOS CT INTERSECTION	960 DEL NORTE WAY / 992 PALO ALTO CT INT.	0.20				7
443	PACKARD AVE	36 HMT SMTVLE RD	322 SARTORI AVE	0.34	06H15	06D	340	7
684	PADDINGTON WAY	681 LEIGHTON GROVE DRIVE	697 ISLESWORTH WAY	0.79	06H25	10E	790	7
995	PALMER DRIVE	997 WOODS DRIVE	E SUBDIVISION BDRY (DANTONI RD)	0.20				7
992	PALO ALTO COURT	960 DEL NORTE WAY / 989 PACIFIC GROVE WAY INT	END	0.05				7
372	PARK AVE	END	END	0.78	06H15	05E	780	7
10000	PAR COURT	823 KATRINA DRIVE	END	0.03				7
465	PARK CIRCLE	464 WOODLAND DR	464 WOODLAND DR	0.58	06H15	05F	580	7
474	PARK CT	465 PARK CIRCLE	END	0.02	06H15	05E	20	7
917	PARKERSON WAY	915 IVY HATCH WAY	EAST SUBDIVISION BOUNDARY	0.02	06H35	02F	20	7
917	PARKERSON WAY	NW SUBDIVISION BDRY (PLUMAS LAKE PH 4)	979 CROWDER WAY	0.09				7
812	PARTRIDGE PARKWAY	498 ARCANO AVENUE	END	0.20	625	03E	200	7
321	PASADO RD	321 PASADO RD	22 ARBOGA RD	0.47	06H15	07C	470	7
272	PAT LN	271 VICKIE DR	END	0.08	07G41	05F	80	7
887	PEACH TREE DRIVE	885 CLING DRIVE	659 RIVERBANK DRIVE	0.22	06H15	06H	220	7
887	PEACH TREE DRIVE	659 RIVER BANK DRIVE	948 WOODLET STREET	0.06	06H25	06H	60	7
887	PEACH TREE DRIVE	948 WOODLET STREET	949 HARVEST STREET	0.05	06H25	06H	50	7
768	PEARL WAY	767 POTOMAC WAY	END	0.02	2	09B	20	7
768	PEARL WAY	WEST SUBDIVISION BOUNDARY (RM 3)	985 CANADIAN WAY INTERSECTION	0.09				7
773	PECOS WAY	772 COLORADO DRIVE	END	0.37	2	09B	370	7
899	PEMBROKE DRIVE	44 RIVER OAKS BLVD	E SUBDIVISION BOUNDRY	0.05	2	09C	50	7
899	PEMBROKE DRIVE	W SUBDIVISION BOUNDRY	915 IVY HATCH WAY	0.03	7G	03J	30	7
120	PENDOLA EXT	119 PENDOLA RD	123 WEEDS POINT RD	5.20	07G	03H	5200	7
119	PENDOLA RD	117 OLD CMPTNV RD	120 PENDOLA EXT	3.25	07G1	03A	3250	7
9	PEORIA RD	SH020	8 MARYSVILLE RD	5.79	07G	07C	5790	6
868	PERRIN WAY	22 ARBOGA ROAD	876 PITTENGER DRIVE	0.03	06H25	02E	30	7
806	PHEASANT RUN DRIVE	22 ARBOGA ROAD	812 PARTRIDGE PARKWAY	0.29	625	03E	290	7
116	PIKE CITY RD	146 CLEVELAND AVE	TAHOE NF BDRY	1.46	07G1	04A	1460	7
116	PIKE CITY RD	SIE CO	TAHOE NF BDRY	2.00	07G	04J	2000	7
958	PINE CREEK PLACE	953 JEWEL LAKE WAY	END	0.03	06H35	04G	30	7
162	PINE MEADOW RD	1 LA PORTE RD	END	0.16	1	06D	159	7
470	PINEWOOD WAY	469 FERNWOOD DR	END	0.36	06H15	06F	360	7
876	PITTENGER DRIVE	868 PERRIN WAY	869 TARRANT DRIVE	0.06	06H25	02E	60	7
876	PITTENGER DRIVE	S SUBDIVISION BOUNDRY (DRN 2)	10018 BOB HAYES DRIVE	0.10	06H25	02E	60	7
242	PLANTZ RD	SH020	1037	0.51	06G55	09F	510	7
25	PLUMAS ARBOGA RD	405 ALGODON RD	26 FORTY MILE RD	1.60	06H25	07G	1599	5
25	PLUMAS ARBOGA RD	43 FEATHER RIVER BOULEVARD	22 ARBOGA ROAD	1.08	06H25	07D	1080	5
25	PLUMAS ARBOGA RD	URBAN LIMIT	405 ALGODON RD	2.21	06H25	05G	2210	5

**EXHIBIT A
2024 YUBA COUNTY
MAINTAINED ROAD DATA**

ROAD NUMBER	ROAD NAME	FROM - NUMBER AND NAME	TO - NUMBER AND NAME	LENGTH MILES	MAP NUMBER	MAP COORDINATE	MILEAGE FROM TABS	FUNCT. CLASS
25	PLUMAS ARBOGA RD	22 ARBOGA ROAD	URBAN LIMIT	0.63	06H25	04E	630	5
301	PLUMAS AVE	END	43 FEATHER RIVER RD	0.49	06H25	04C	490	7
45	PLUMAS LAKE BLVD	405 ALGODON RD	EAST END @ SH070	0.70	06H25	08F	340	5
758	PLUMAS LINKS STREET	757 STARFLOWER STREET	END	0.26	06H25	03D	260	7
584	PLUMAS SCHOOL RD	25 PLUMAS ARBOGA RD	430 OLD FORTY MILE RD	1.03	06H25	07K	1027	7
409	PLUTE RD	334 OSTRUM RD	END	0.29	06H25	02K	290	7
594	POINT DEFIANCE COURT	592 INDEPENDENCE TRAIL	END	0.09	06H25	08F	90	7
567	POLLYWOG COURT	569 SHORELINE DRIVE	END	0.05	06H15	06F	50	7
568	POND VIEW DR	566 EDGEWATER CIR	364 RUPERT AVE	0.49	06H15	06E	60	7
704	PONDEROSA RANCH WAY	606 COFFEE CREEK WAY	706 THUNDER RANCH WAY	0.15	06H25	08F	150	7
164	PONDEROSA WY	1 LA PORTE RD	1058 PONDEROSA WAY	0.64	07G	04D	650	7
311	POPLAR AVE	314 CEDAR LANE	441 RIVERSIDE DR	0.31	06H15	06B	310	7
660	POPPY WAY	659 RIVER BANK DRIVE	580 WATERFALL DRIVE	0.11	06H15	06E	110	7
767	POTOMAC WAY	766 POWDER WAY	765 CIMARRON DRIVE	0.33	2	09B	330	7
766	POWDER WAY	44 RIVER OAKS BLVD	END	0.17	2	09B	170	7
243	POWELL RD	242 PLANTZ ROAD	END	0.70	06G55	09F	700	7
357	POWERLINE RD	31 OLIVEHURST AVE	32 MC GOWAN PKWY	1.86	06H15	08E	1860	5
647	PRESIDO WAY	648 LAKEPORT WAY	644 TIBURON WAY	0.17	2	09B	170	7
628	PUDDLE DRIVE	364 RUPERT AVE	END	0.10	06H15	06F	100	7
814	PURPLE MARTIN ROAD	498 ARCANO AVENUE	END	0.03	625	03E	30	7
814	PURPLE MARTIN ROAD	498 ARCANO AVENUE	SOUTH SUBDIVISION BOUNDARY	0.19	06H25	02F	190	7
715	PYRAMID CREEK DRIVE	479 BAYWOOD DRIVE	717 NORTH FORK	0.31	06H15	06F	310	7
983	QUAY COURT	687 NOTTING HILL WAY	END	0.04				7
691	RAINHAM COURT	681 LEIGHTON GROVE DRIVE	END	0.08	06H25	10E	80	7
13	RAMIREZ RD	SH070	BUT CO	7.49	06G	08H	7490	5
20	RANCHO RD	URL .1M S/MCGOWAN PKWY	OSTROM RD	0.80	06H25	02J	800	6
20	RANCHO RD	SH065	OSTROM RD	2.69	2	08C	3490	7
20	RANCHO RD	URBAN LIMIT	32 MCGOWAN PKWY	0.10	06H25	01J	100	5
20	RANCHO RD	32 MCGOWAN PKWY	END	0.34	06H25	01H	340	7
625	RAPID WATER WAY	568 POND VIEW DR	END	0.13	06H15	06E	130	7
581	RAVINE COURT	578 SHALLOW CREEK DR	END	0.02	06H15	06E	20	7
737	RAZORBILL STREET	736 BAMBOO STREET	746 DEERWOOD STREET	0.06	06H25	03D	60	7
371	REDBURN AVE	35 N BEALE ROAD	427 ASH WAY	0.15	06H15	05E	150	7
10002	REDFORD WAY	N SUBDIVISION BDRY (PLUMAS LAKE PH 6)	END (CUL-DE-SAC)	0.12				7
845	REDGOLD STREET	34 GRIFFITH AVENUE	END	0.25	06H15	05H	250	7
845	REDGOLD STREET	E SUBDIVISION BOUNDRY (OP 7)	923 SUNHAVEN STREET	0.07	06H15	06H	90	7
920	REDHAVEN STREET	882 FREESTONE DRIVE	END	0.02	06H15	06H	20	7
920	REDHAVEN STREET	923 SUNHAVEN STREET	W SUBDIVISION BOUNDRY (OP 7)	0.15	06H15	06H	90	7
284	REDHILL RD	220 DOLAN HARDING R	285 REDHILL WY	1.12	07G	08C	1120	7
389	REDWOOD AVE	22 ARBOGA ROAD	END	0.05	06H15	06C	50	7
478	REDWOOD CT	469 FERNWOOD DR	END	0.04	06H15	06E	40	7
897	REMINGTON WAY	896 MANCHESTER DRIVE	RIVERBANK DRIVE	0.08	06H15	06G	80	7
202	RICES CROSSING RD	8 MARYSVILLE RD	1057 RICES CROSSING RD	3.68	07G	06E	3680	6
203	RICES TEX HILL RD	202 RICES CROSSING	138 TEXAS HILL RD	2.51	07G	06E	2510	7
425	RICH RD	43 FEATHER RIVER RD	END	0.42	06H25	08C	420	7
573	RICK DR	572 TREVOR DR	END	0.19	06H15	04G	23	7
159	RIDGE RD	SH049	END YC MAINTAINED	0.26	1	07H	260	5

**EXHIBIT A
2024 YUBA COUNTY
MAINTAINED ROAD DATA**

ROAD NUMBER	ROAD NAME	FROM - NUMBER AND NAME	TO - NUMBER AND NAME	LENGTH MILES	MAP NUMBER	MAP COORDINATE	MILEAGE FROM TABS	FUNCT. CLASS
159	RIDGE RD	END YC MAINTAINED	S180 SIE CO RD	3.70	1	07H	3960	5
595	RIM COURT	594 POINT DEFIANCE COURT	END	0.02	06H25	08F	20	7
967	RIO GRANDE DRIVE	765 CIMARRON DRIVE	N SUBDIVISION BOUNDRY (RSM 5)	0.30	2	09B	290	7
967	RIO GRANDE DRIVE	SE SUBDIVISION BDRY (RIVERSIDE MEADOWS V.3)	765 CIMARRON DRIVE	0.40				7
718	RIPTIDE WAY	715 PYRAMID CREEK DRIVE	716 WHITEWATER DRIVE	0.05	06H15	06F	50	7
837	RITA COURT	888 KATRINA DRIVE	END	0.02	06H15	04H	20	7
659	RIVER BANK DR	566 EDGEWATER CIRCLE	879 GOLDFIELDS PKWY	0.62	06H15	06E	400	5
659	RIVER BANK DR	581 RAVINE COURT	566 EDGEWATER CIR	0.33	06H15	06E	320	7
659	RIVER BANK DR	879 GOLDFIELDS PKWY	883 SEEDLING WAY	0.08	06H15	06E	80	7
659	RIVER BANK DR	883 SEEDLING WAY	922 GLOWHAVEN STREET	0.11	2	09B	290	7
659	RIVER BANK DRIVE	W SUBDIVISION BOUNDRY (OP 7)	923 SUNHAVEN STREET	0.02	06H15	06H	90	7
966	RIVERBEND COURT	765 CIMARRON DRIVE	END	0.07	2	09B	290	7
44	RIVER OAKS BLVD	43 FEATHER RIVER BLVD	N SUBDIVISION BOUNDRY (ROSS RANCH)	4.56	06H25	08F	3790	4
721	RIVER ROCK DRIVE	822 STONEWOOD LOOP	824 MEADOW BROOK WAY	0.17	06H15	06F	160	7
576	RIVER RUN DR	577 MARSH DR	659 RIVER BANK DR	0.64	06H15	06F	310	7
844	RIVER WOOD DRIVE	822 STONE WOOD LOOP	824 MEADOW BROOK	0.17	06H15	06G	170	7
441	RIVERSIDE DR	43 FEATHER RIVER	310 SYCAMORE AVE	0.81	06H15	06B	810	5
441	RIVERSIDE DR	310 SYCAMORE AVE	END	0.19	06H15	05B	190	7
100	ROAD 100	1 LA PORTE RD	1 LA PORTE RD	0.35	1	04G	350	7
639	ROARING CAMP COURT	635 BIDWELL BAR DRIVE	END	0.13	06H25	08F	130	7
826	ROARING RAPIDS WAY	822 STONEWOOD LOOP	721 RIVER ROCK DRIVE	0.12	06H15	06G	120	7
586	ROBERTA AVENUE	544 SUTTER ST	END	0.26	06H15	05G	260	7
827	ROCK CLIFF COURT	721 RIVER ROCK DRIVE	END	0.03	06H15	06G	30	7
769	ROCKWOOD COURT	765 CIMARRON DRIVE	END	0.08	2	09B	80	7
558	RODEO WY	543 DONALD DR	541 DEATON DR	0.15	06H25	01F	150	7
796	ROHNERT COURT	786 RUTHERFORD WAY	END	0.05	2	09B	50	7
950	ROOTSTOCK WAY	948 WOODLET STREET	949 HARVEST STREET	0.06	06H25	06H	60	7
336	ROSE AVE	32 MC GOWAN PKWY	337 MAGE AVENUE	0.27	06H25	01H	270	7
890	ROSS RANCH CIRCLE	44 RIVER OAKS BLVD	405 ALGODON ROAD	0.51	06H25	06F	510	7
585	ROSSER ROAD	26 FORTY MILE RD	END	0.62	06H25	03J	620	7
50	ROUTE 20	HWY 20	END	0.44	2	02F	440	7
910	ROYAL CT	909 HEARTLAND DR	END	0.03	06H25	10F	30	
702	ROY RANCH WAY	605 CALYPSO RANCH DRIVE	706 THUNDER RANCH WAY	0.40	06H25	08F	400	7
364	RUPERT AVE	36 HMT SMTVLE RD	566 EDGEWATER CIR	0.82	06H15	06E	320	5
786	RUTHERFORD WAY	43 FEATHERRIVER BOULEVARD	787 ATHERTON WAY	0.09	2	09B	90	7
316	S GLEDHILL AVE	321 PASADO RD	23 GRAND AVE	0.41	06H15	07C	410	7
771	SABINE COURT	766 POWDER WAY	END	0.08	2	09B	80	7
508	SABINIANA RD	507 LOBATA RD	END	0.23	07G	07C	230	7
241	SADDLEBACK DR	SH070	241 SADDLEBACK DR	0.98	06G55	07A	980	7
892	SAINT ANDREWS DRIVE	894 NIBLICK WAY	891 BERMUDA DRIVE	0.68	06H25	06F	680	7
623	SALMON DRIVE	568 POND VIEW DR	END	0.08	06H15	06F	80	7
991	SAN ANSELMO COURT	989 PACIFIC GROVE WAY	END	0.09				7
10024	SAN JUAN COURT	E SUBDIVISION BDRY (CIMARRON DRIVE)	END	0.06				7
862	SAND CASTLE WAY	580 WATERFALL DRIVE	566 EDGEWATER CIR	0.08	06H15	06E	80	7
713	SAND DOLLAR DRIVE	479 BAYWOOD DRIVE	719 WATERFRONT COURT	0.39	06H15	06F	390	7
798	SANTA BARBARA WAY	44 RIVER OAKS BLVD	801 STINSON WAY	0.25	2	09B	250	7
797	SANTA CRUZ DRIVE	44 RIVER OAKS BLVD	798 SANTA BARBARA WAY	0.19	2	09B	190	7

**EXHIBIT A
2024 YUBA COUNTY
MAINTAINED ROAD DATA**

ROAD NUMBER	ROAD NAME	FROM - NUMBER AND NAME	TO - NUMBER AND NAME	LENGTH MILES	MAP NUMBER	MAP COORDINATE	MILEAGE FROM TABS	FUNCT. CLASS
322	SARTORI AVE	443 PACKARD AVE	21 LINDHURST AVE	0.20	06H15	06D	200	7
434	SCALES AVENUE	21 LINDHURST AVE	END	0.19	06H15	06D	190	7
2	SCALES RD	1 LA PORTE RD	SIE CO	7.81	1	03H	7810	7
149	SCHOOL ST	148 MILL STREET	146 CLEVELAND AVE	0.18	07G1	03B	180	7
222	SCOTT FORBES RD	9 PEORIA ROAD	1055	5.05	07G	08C	5050	7
205	SCOTT GRANT RD	8 MARYSVILLE RD	10 LOMA RICA RD	1.56	2	01E	1560	7
851	SCOTTSCRAIG COURT	849 LOHCARRON DRIVE	END	0.02	06H15	05H	20	7
911	SEABISCUIT WY	673 HIGH NOON DR	909 HEARTLAND DR	0.13	2	09B	130	7
804	SEA CLIFF COURT	800 MONTEREY WAY	END	0.03	2	09B	30	7
805	SEA SIDE COURT	800 MONTEREY WAY	END	0.06	2	09B	60	7
340	SECOND AVE	444 CHESTNUT RD	END	0.41	06H15	08E	410	7
589	SECRET LAKE TRAIL	593 CANYON CREEK TRAIL	END	0.24	06H25	08F	240	7
883	SEEDLING WAY	878 AUTUMN LANE	659 RIVER BANK DR	0.21	06H15	06H	180	7
883	SEEDLING WAY	659 RIVER BANK DRIVE	919 NECTAR WAY	0.12	06H15	06H	120	7
883	SEEDLING WAY	S SUBDIVISION BOUNDRY (OP 7)	REDHAVEN STREET	0.07	06H15	06H	90	7
883	SEEDLING WAY	NORTH SUBDIVISION BOUNDARY (SOE)	968 SWAISY DRIVE	0.09				7
455	SEVENTEENTH ST	357 POWERLINE RD	355 FLEMING WAY	0.24	06H25	01G	240	7
345	SEVENTH AVE	22 ARBOGA RD	357 POWERLINE RD	0.98	06H15	09D	980	5
724	SEYKOTA AVENUE	723 BRIANNA AVENUE	END	0.13	06H25	01F	130	7
429	SHAD RD	35 N BEALE ROAD	END	0.39	06H15	05B	390	7
578	SHALLOW CREEK DR	END	566 EDGEWATER CIR	0.05	06H15	06F	54	7
366	SHARP AVE	443 PACKARD AVE	21 LINDHURST AVE	0.11	06H15	06D	110	7
398	SHASTA WAY	372 PARK AVENUE	END	0.15	06H15	05E	150	7
973	SHASTINA WAY	959 SKIPPER COVE WAY	972 JAMISON CREEK WAY	0.13	2	09B	180	7
733	SHAY AVENUE	730 CHYSTAL COURT	734 HICKS AVENUE	0.16	06H25	01F	160	7
229	SHELL RD NO 2	14 WOODRUFF LANE	END	0.30	06G55	04A	300	7
612	SHERIDAN RANCH CIRCLE	613 LINDENMEIR DRIVE	613 LINDENMEIR DRIVE	0.20	06H25	08F	200	7
413	SHIMER RD	20 RANCHO RD	409 PLUTE RD	0.19	06H25	02J	280	7
841	SHIRES WAY	659 RIVERBANK DRIVE	834 MOSS GLEN LOOP	0.20	06H15	06G	200	7
754	SHOOTING STAR STREET	751 WATER LEAF STREET	753 SUTTER TRAILS STREET	0.08	06H25	03D	80	7
569	SHORELINE DRIVE	364 RUPERT AVE	369 GROVE AVE	0.41	06H15	06E	410	7
530	SHORT CT	527 LISA WY	END	0.03	06H15	05D	30	7
223	SICARD FLAT RD	SH020	9 PEORIA ROAD	1.38	07G	09C	1380	7
750	SIERRA BLUFF STREET	WHEELER RANCH DRIVE	751 WATER LEAF STREET	0.09	06H25	03D	90	7
970	SIERRA PINES PLACE	971 SILVER CREEK CIRCLE	END	0.07	2	09B	190	7
451	SIERRA WAY	449 TYLER AVE	448 BEEDE AVE	0.09	06H15	05E	90	7
232	SILVA AVE	SH070	END	0.93	06G55	09A	930	7
971	SILVER CREEK CIRCLE	969 KNOTTY PINE WAY	951 BERRYESSA WAY	0.23	2	09B	180	7
912	SILVER SAGE CT	909 HEARTLAND DR	END	0.06	06H25	10F	60	7
710	SILVER SPUR WAY	606 COFFEE CREEK WAY	712 SLINGSHOT DRIVE	0.36	06H25	08F	360	7
534	SILVERLEAF CT	532 GOLD LEAF WY	END	0.02	06H25	01G	20	7
525	SILVERWOOD ST	35 NORTH BEALE RD	527 LISA WY	0.17	06H15	05D	170	7
17	SIMPSON LANE	URBAN BOUNDRY	MARYSVILLE CL	1.72	06H15	04E	1718	4
17	SIMPSON LANE	36 HMT SMTVLE RD	URBAN BOUNDRY	0.16	06H15	04E	162	4
384	SIMPSON-DANTONI RD	387 DANTONI ROAD	17 SIMPSON LANE	1.19	06H15	03G	1190	7
836	SIR BARTON DRIVE	833 EGYPTIAN WAY	834 BUCKSKIN WAY	0.12	06H25	01E	120	7
433	SIXTEENTH ST	354 ARDMORE AVE	357 POWERLINE RD	0.36	06H25	01F	360	7

**EXHIBIT A
2024 YUBA COUNTY
MAINTAINED ROAD DATA**

ROAD NUMBER	ROAD NAME	FROM - NUMBER AND NAME	TO - NUMBER AND NAME	LENGTH MILES	MAP NUMBER	MAP COORDINATE	MILEAGE FROM TABS	FUNCT. CLASS
344	SIXTH AVE	END	357 POWERLINE RD	0.72	06H15	09E	720	7
732	SKINNER AVENUE	733 SHAY AVENUE	726 SUNDARI AVENUE	0.14	06H25	01F	140	7
959	SKIPPER COVE WAY	866 CHALICE CREEK DRIVE	973 SHASTINA WAY	0.05	2	09B	180	7
24	SKY HARBOR DR	22 ARBOGA ROAD	END	0.28	06H15	09D	280	7
482	SKYCREST DR	481 CATALPA ST	514 ACACIA WY	0.06	06H15	07E	60	7
748	SKYLINE COURT	END	END	0.11	06H25	03D	110	7
583	SKYWAY DR	22 ARBOGA ROAD	END	1.30	6H15	10E	1300	7
712	SLINGSHOT DRIVE	614 DARK HORSE WAY	708 BROKEN SPUR WAY	0.21	06H25	08F	210	7
19	SMARTSVILLE RD	SH020	SH020	1.21	07G53	06C	1210	7
211	SMITH RD	10 LOMA RICA RD	END	0.85	07G41	04G	850	7
776	SNOW GOOSE STREET	777 GOLDEN PLOVER STREET	780 SNOWY EGRET STREET	0.11	06H25	03D	110	7
780	SNOWY EGRET STREET	776 SNOW GOOSE STREET	778 FLAMINGO STREET	0.21	06H25	03D	210	7
30	SO BEALE RD	SH065	1021 BEALE AFB BDRY	3.18	2	08C	3180	5
588	SOLDIERS RANCH WAY	589 SECRET LAKE TRAIL	607 BROAD ACRES WAY	0.19	06H25	08F	190	7
658	SOPHIA STREET	496 MAPLEHURST ST	537 CHATEAU DRIVE	0.12	06H25	11E	120	7
267	SOUTH ROBERTA WAY	234 DOC ADAMS RD	END	0.03	06H15	01A	30	7
987	SOUTH SHORE WAY	767 POTOMAC WAY INTERSECTION	985 CANADIAN WAY INTERSECTION	0.14				7
603	SPANISH RANCH WAY	605 CALYPSO RANCH DRIVE	600 ZANES DRIVE	0.14	06H25	08F	140	7
305	SPECKERT RD	384 SIMPSN DNTNI	END	0.39	06H15	03F	390	7
145	SPENCER ST	END	116 PIKE CITY RD	0.10	07G1	04B	100	7
40	SPENCEVILLE RD	50 FEET NORTH OF ERICK ROAD	BEALE AFB BDRY	1.74	2	08D	6490	5
40	SPENCEVILLE RD	41 LONG RAVINE RD	39 WALDO RD	0.40	2	06F	400	6
40	SPENCEVILLE RD	BEALE AFB BDRY	1017	1.22	2	07F	1220	7
40	SPENCEVILLE RD	1017	NEV CO	2.17	2	06F	2570	7
562	SPINNAKER WY	360 LINDA AVE	END	0.06	06H15	05E	60	7
10022	SPRING CREEK WAY	10023 MADISON COURT	W SUBDIVISION BDRY (RIVERSIDE MEADOWS V. 3/4)	0.09				7
147	SPRING ST	146 CLEVELAND AVE	148 MILL STREET	0.26	07G1	04A	260	7
216	SPRING VALLEY RD	SH020	8 MARYSVILLE RD	5.70	07G	09A	5700	7
377	STAR AVE	35 N BEALE ROAD	379 SUN AVENUE	0.34	2	06C	340	7
757	STARFLOWER STREET	756 TWINBERRY STREET	758 PLUMAS LINKS STREET	0.07	06H25	03D	70	7
965	ST. CROIX COURT	967 RIO GRANDE DRIVE	END	0.06	2	09B	290	7
528	STEPHENSON ST	525 SILVERWOOD ST	372 PARK AVE	0.25	06H15	05D	250	7
698	STEPNEY WAY	697 ISLESWORTH WAY	END	0.07	06H25	10E	70	7
698	STEPNEY WAY	N SUBDIVISION BDRY (PLUMAS LAKE PH 7)	687 NOTTING HILL WAY	0.29				7
801	STINSON WAY	798 SANTA BARBARA WAY	END	0.19	2	09B	190	7
822	STONE WOOD LOOP	824 MEADOW BROOK WAY	844 RIVER WOOD DRIVE	0.29	06H15	06G	500	7
847	STONEHAVEN DRIVE	360 LINDA AVE	850 WESTHILL DR	0.45	06H15	05H	200	7
268	STONEHEDGE DR	10 LOMA RICA RD	END	0.55	07G	06C	550	7
825	STONEY CREEK WAY	659 RIVERBANK DRIVE	840 WATERVILLE DRIVE	0.19	06H15	06G	190	7
930	SUGARSTICK DRIVE	N SUBDIVISION BOUNDRY (ROE 2)	END	0.33	2	09B	180	7
930	SUGARSTICK DRIVE	933 BALLANTINE WAY	S SUBDIVISION BOUNDRY (ROE 3)	0.27	2	09B	180	7
808	SULLIVAN DRIVE	806 PHEASANT RUN DRIVE	END	0.04	625	03E	40	7
886	SUMMER LAND DRIVE	885 CLING DRIVE	659 RIVERBANK DRIVE	0.23	06H15	06H	230	7
677	SUMMERFIELD LANE	678 JUNE WAY	336 ROSE AVENUE	0.24	06H25	11G	240	7
986	SUMMERWIND COURT	988 BRIDLE CREEK WAY INTERSECTION	END	0.05				7
255	SUMMIT AVE	254 NORTH AVE	10 LOMA RICA RD	0.07	07G41	03H	70	7
379	SUN AVE	376 BROPHY ROAD	378 MOON AVENUE	0.36	2	06C	380	7

**EXHIBIT A
2024 YUBA COUNTY
MAINTAINED ROAD DATA**

ROAD NUMBER	ROAD NAME	FROM - NUMBER AND NAME	TO - NUMBER AND NAME	LENGTH MILES	MAP NUMBER	MAP COORDINATE	MILEAGE FROM TABS	FUNCT. CLASS
674	SUNDANCE DRIVE	675 LONG HORN TRAIL	641 KNIGHTS FERRY DRIVE	0.42	06H25	08F	130	7
726	SUNDARI AVENUE	723 BRIANNA AVENUE	734 HICKS AVENUE	0.35	06H25	01F	350	7
923	SUNHAVEN STREET	33 ERLE ROAD	878 AUTUMN LANE	0.09	06H15	06H	90	7
923	SUNHAVEN STREET	S SUBDIVISION BOUNDRY (OP 7)	360 LINDA AVE	0.41	06H15	06H	90	7
492	SUNNY RD	END	BUTTERFLY LANE	0.03	06H25	01E	30	7
492	SUNNY RD	END	BUTTERCOUP LN	0.02	06H25	01E	20	7
492	SUNNY RD	BUTTER CUP LN	BUTTERFLY LN	0.12	06H25	01E	120	7
381	SUNRISE AVE	END	380 DUNNING AVE	0.10	06H15	04F	100	7
383	SUNSET AVE	380 DUNNING AVE	END	0.10	06H15	05F	100	7
382	SUNSHINE AVE	383 SUNSET AVE	381 SUNRISE AVE	0.15	06H15	05F	150	7
544	SUTTER ST	35 NORTH BEALE RD	END	0.20	06H15	05F	203	7
753	SUTTER TRAILS STREET	750 SIERRA BLUFF STREET	756 TWINBERRY STREET	0.18	06H25	03D	150	7
968	SWAISY DRIVE	883 SEEDLING WAY	922 GLOWHAVEN STREET	0.05				7
310	SYCAMORE AVE	441 RIVERSIDE DR	315 GARDEN AVE	0.13	06H15	05B	130	7
631	TABLE MOUNTAIN DRIVE	44 RIVER OAKS BLVD	641 KNIGHTS FERRY DRIVE	0.18	06H25	08F	180	7
570	TADPOLE WAY	569 SHORELINE DRIVE	564 CATTAIL DR	0.12	06H15	06F	120	7
749	TAHOE STREET	748 SKYLINE COURT	750 SIERRA BLUFF STREET	0.06	06H25	03D	60	7
975	TAMARACK COURT	972 JAMISON CREEK WAY	END	0.04	2	09B	190	7
225	TANABE RD	226 MATHEWS LN	13 RAMIREZ RD	3.68	06G55	03F	3680	7
774	TANANA COURT	773 PECOS WAY	END	0.08	2	09B	80	7
869	TARRANT DRIVE	876 PITTENGER DRIVE	W SUBDIVISION BOUNDRY	0.08	06H25	02E	80	7
155	TAYLOR WAY	152 MELLON WAY	170 NORTH LOOP RD	0.06	07G1	02G	60	7
348	TENTH AVE	355 FLEMING WAY	357 POWERLINE RD	0.25	06H15	10F	250	7
348	TENTH AVE	351 WESTERN AVE	31 OLIVEHURST AVE	0.25	06H15	10E	250	7
517	TERRY CT	419 BAUGH ST	END	0.06	06H25	01F	60	7
138	TEXAS HILL RD	8 MARYSVILLE RD	290 OLD DOBBINS RD	2.78	07G	06E	2780	7
693	THAMES COURT	687 NOTTING HILL WAY	END	0.05	06H25	10E	50	7
341	THIRD AVE	END	444 CHESTNUT RD	0.43	06H15	08E	430	7
300	THIRTEENTH ST	31 OLIVEHURST AVE	354 ARDMORE AVE	0.11	06H15	10E	110	7
213	THOME RD	214 LAUREL LANE	END	0.75	06G44	04J	750	7
624	THREE RIVERS DRIVE	623 SALMON DR	END	0.23	06H15	06F	230	7
706	THUNDER RANCH WAY	600 ZANES DRIVE	END	0.28	06H25	08F	280	7
644	TIBURON WAY	652 LOCKWOOD DRIVE	END	0.45	2	09B	450	7
720	TIDE POOL COURT	714 FALL RIVER DRIVE	END	0.04	06H15	06F	40	7
259	TIMBUCTOO RD	SH020	SH020	2.26	07G	09C	2260	7
520	TISH CIR	317 ALICIA AVE	END	0.25	06H15	06C	250	7
221	TOWNSHIP RD	9 PEORIA RD	220 DOLAN HARDING RD	3.67	07G	09C	3670	7
745	TRAIL LEAF STREET	746 DEERWOOD STREET	736 BAMBOO STREET	0.06	06H25	03D	60	7
686	TRAILHEAD LOOP	659 RIVERBANK DRIVE	659 RIVER BANK DRIVE	0.18	06H15	06E	180	7
574	TREVOR CT	572 TREVOR DR	END	0.02	06H15	04G	20	7
572	TREVOR DR	36 HMT SMTVLE RD	END	0.14	06H15	04G	140	7
572	TREVOR DRIVE	999 MICKELSON DRIVE	SUBDIVISION BDRY (BUTLER ESTATES)	0.07				7
984	TRINITY COURT	768 PEARL WAY INTERSECTION	END	0.06				7
903	TUDOR WAY	901 GARNET WAY	E SUBDIVISION BOUNDRY	0.00	2	09C	3	7
903	TUDOR WAY	E SUBDIVISION BOUNDRY	END	0.08	06H35	03F	79	7
445	TULIP ROAD	21 LINDHURST AVE	END	0.11	06H15	08F	110	7
350	TULSA AVE	345 SEVENTH AVE	344 SIXTH AVE	0.19	06H15	09E	190	7

**EXHIBIT A
2024 YUBA COUNTY
MAINTAINED ROAD DATA**

ROAD NUMBER	ROAD NAME	FROM - NUMBER AND NAME	TO - NUMBER AND NAME	LENGTH MILES	MAP NUMBER	MAP COORDINATE	MILEAGE FROM TABS	FUNCT. CLASS
556	TUMBLEWEED WY	543 DONALD DR	541 DEATON DR	0.15	06H25	01F	150	7
848	TURNBERRY DRIVE	33 ERLE ROAD	N SUBDIVISION BOUNDRY	0.49	06H15	05H	490	7
848	TURNBERRY DRIVE	N SUBDIVISION BOUNDRY	904 GLASGLOW DRIVE	0.02	06H15	05H	18	7
848	TURNBERRY DRIVE	904 GLASGLOW DRIVE	849 LOHCARRON DRIVE	0.05	06h15	05h	51	7
689	TURNBRIDGE WAY	686 BELVEDERE WAY	698 STEPNEY WAY	0.21	06H25	10E	210	7
457	TURPEN ST	357 POWERLINE RD	END	0.21	06H15	09E	210	7
461	TWAIN DR	460 EVELYN DR	END	0.25	06H25	01G	250	7
758	TWINBERRY STREET	757 STARFLOWER STREET	856 WHEELER RANCH DRIVE	0.21	06H25	03D	220	7
571	TWISTED RIVER DR	364 RUPERT AVE	END	0.43	06H15	06E	160	7
449	TYLER AVE	360 LINDA AVE	450 INEZ WAY	0.13	06H15	05E	130	7
539	VALLEY MEADOWS DRIVE	499 BIGLOW DR	658 SOPHIA STREET	0.26	06H25	02F	91	7
739	VELVET LEAF STREET	736 BAMBOO STREET	740 LADY FERN STREET	0.12	06H25	03D	118	7
791	VENTANA COURT	787 ATHERTON WAY	END	0.04	2	09B	40	7
271	VICKIE DR	264 HILL ROAD	264 HILL ROAD	0.77	07G41	04F	770	7
101	VIERRA RD	1 LA PORTE RD	BUT CO	4.61	07G	04D	4610	7
318	VINE AVE	317 ALICIA AVE	END	0.13	06H15	07C	130	7
473	VINE CT	464 WOODLAND DR	END	0.02	06H15	05F	20	7
500	VINEYARD RD	907 CHUCK YEAGER RD	END	0.43	2	05F	430	7
462	VIRGILIA LANE	461 TWAIN DRIVE	461 TWAIN DRIVE	0.34	06H25	01G	340	7
307	VIRGINIA AVE	EAST LINE TRLIA SETBACK LEVEE R/W	43 FEATHER RIVER BLVD	0.18	06H15	08C	190	7
210	VIRGINIA RD	211 SMITH ROAD	END	1.05	07G41	04G	1050	7
333	VIRGINIA RD	20 RANCHO RD	33 ERLE ROAD	3.73	2	07C	3730	7
854	VISTA DRIVE	674 SUNDANCE DRIVE	853 BROKEN BIT DRIVE	0.13	06H25	09F	130	7
454	VOLK STREET	372 PARK AVE	369 GROVE AVE	0.11	06H15	06E	110	7
238	W HALLWOOD BLVD	237 KIMBALL LANE	SH020	1.50	06G55	06F	1500	7
10021	WABASH COURT	967 RIO GRANDE DRIVE	END	0.05				7
977	WAGGONER COURT	S SUBDIVISION BDRY (PLUMAS LAKE PH 5)	END	0.07				7
39	WALDO RD	40 SPENCEVILLE RD	907 CHUCK YEAGER RD	1.90	2	06F	1900	6
167	WALKER MILL RD	159 RIDGE ROAD	END	0.53	07G	05H	530	7
701	WALLABY RANCH WAY	703 LOST CREEK DRIVE	605 CALYPSO RANCH DRIVE	0.11	06H25	08F	110	7
818	WALLEN DRIVE	36 HAMMONTON-SMARTVILLE ROAD	815 HABITAT WAY	0.25	06H15	04J	250	7
38	WALNUT AVE	240 HALLWOOD BLVD	END	1.02	06G55	07J	1020	7
38	WALNUT AVE	SH020	240 HALLWOOD BLVD	1.86	06G55	08F	1860	7
437	WAREHOUSE RD	437 BROADWAY	END	0.22	06H25	04E	220	7
751	WATER LEAF STREET	752 IRONWOOD STREET	753 SUTTER TRAILS STREET	0.12	06H25	03D	120	7
580	WATERFALL DRIVE	582 WETLAND DR	576 RIVER RUN DR	0.02	06H15	06E	20	7
719	WATERFRONT COURT	713 SAND DOLLAR DRIVE	END	0.10	06H15	06F	100	7
665	WATERHOLE LOOP	659 RIVERBANK DRIVE	659 RIVER BANK DRIVE	0.18	06H15	06E	180	7
840	WATERVILLE DRIVE	824 MEADOW BROOK WAY	END	0.22	06H15	06G	220	7
671	WAWONA COURT	635 BIDWELL BAR DRIVE	END	0.06	06H25	08F	60	7
123	WEEDS POINT RD	SH049	119 PENDOLA ROAD	4.02	07G1	03A	4020	7
487	WERNER ST	485 LEVER AVE	488 MARTEL DR	0.04	06H25	01H	40	7
324	WEST ELLA AVE	323 ELLA AVE	END	0.18	06H25	02C	180	7
351	WESTERN AVE	340 SECOND AVE	349 ELEVENTH AVE	1.13	06H15	08E	1130	7
850	WESTHILL DRIVE	847 STONEHAVEN DRIVE	849 LOHCARRON DRIVE	0.13	06H15	05H	130	7
788	WESTPORT WAY	787 ATHERTON WAY	END	0.11	2	09B	110	7
788	WESTPORT WAY	W SUBDIVISION BOUNDRY (PLUMAS RANCH V. 6)	919 PACIFIC GROVE WAY	0.03				7

**EXHIBIT A
2024 YUBA COUNTY
MAINTAINED ROAD DATA**

ROAD NUMBER	ROAD NAME	FROM - NUMBER AND NAME	TO - NUMBER AND NAME	LENGTH MILES	MAP NUMBER	MAP COORDINATE	MILEAGE FROM TABS	FUNCT. CLASS
582	WETLAND DRIVE	577 MARSH DR	580 WATERFALL DRIVE	0.04	06H15	06E	40	7
28	WHEATLAND RD	SUTTER CO LN	.39 M E OF CNTY LN @ GRASSHOPPER	0.39	2	09D	1940	5
856	WHEELER RANCH DRIVE	855 LINKS PARKWAY	855 LINKS PARKWAY	0.70	06H25	03D	700	7
108	WHITEHEAD RD	110 BEAN CLIPPER RD	END	0.41	07G	03G	410	7
716	WHITEWATER DRIVE	479 BAYWOOD DRIVE	718 RIPTIDE WAY	0.25	06H15	06F	260	7
374	WIGET AVE	35 N BEALE ROAD	427 ASH WAY	0.14	06H15	05E	140	7
602	WILCOX RANCH ROAD	600 ZANES DRIVE	44 RIVER OAKS BLVD	0.34	06H25	08F	340	7
664	WILDERNESS LOOP	659 RIVERBANK DRIVE	659 RIVER BANK DRIVE	0.18	06H15	06E	180	7
468	WILDWOOD DR	465 PARK CIRCLE	716 WHITEWATER DRIVE	0.10	06H15	05F	240	7
132	WILLIAMS ROAD	135 INDIANA RANCH RD	END	1.18	07G	05E	1180	7
126	WILLOW CR RD	117 OLD CMPTNV RD	1064 WILLOW CR RD	0.42	1	06H	420	7
4	WILLOW GLEN RD	8 MARYSVILLE RD	1 LA PORTE RD	7.79	07G	06D	7790	5
794	WINDSOR COURT	786 RUTHERFORD WAY	END	0.07	2	09B	70	7
466	WOODLAND CIRCLE	464 WOODLAND DR	464 WOODLAND DR	0.15	06H15	05F	150	7
464	WOODLAND DR	35 N BEALE ROAD	466 WOODLAND CIR	0.27	06H15	05F	270	7
948	WOODLET STREET	887 PEACH TREE DRIVE	881 COBBLER LANE	0.15	06H25	06H	150	7
14	WOODRUFF LANE	SH070	SH020	5.13	06G54	04A	5130	5
997	WOODS DRIVE	998 NICKLAUS DRIVE	996 HOGAN WAY	0.19				7
725	WREN COURT	697 ISLESWORTH WAY	END	0.03				7
10020	WYOMIA TYUS WAY	10017 JIM HINES DRIVE	10018 BOB HAYES DRIVE	0.05	06H25	02E	60	7
735	YARROW STREET	740 LADY FERN STREET	736 BAMBOO STREET	0.15	06H25	03D	150	7
122	YOUNGS HILL RD	119 PENDOLA ROAD	123 WEEDS POINT RD	2.52	07G	03H	2520	7
260	YUBA-NEVADA RD	END	138 TEXAS HILL RD	0.69	07G	06E	690	7
10027	YUKON COURT	967 RIO GRANDE DRIVE	END	0.04				7
600	ZANES DRIVE	44 RIVER OAKS BLVD	606 COFFEE CREEK WAY	0.45	06H25	08F	270	7
			TOTAL	667.62				

ROAD NUMBER	ROAD NAME	FROM [NUMBER AND NAME]	TO [NUMBER AND NAME]	LENGTH	VALUE	FUNC. CLASS	DESCRIPTION
2024 YUBA COUNTY ADDED / ABANDONED / VACATED ROADS CLASSIFICATION CHANGES							
ADDED ROAD SEGMENTS							
998	NICKLAUS DRIVE	999 MICKELSON DRIVE	996 HOGAN WAY	0.247		7	NORTH DANTONI RANCH
999	MICKELSON DRIVE	387 DANTONI ROAD	W SUBDIVISION BDRY	0.254		7	TM2021-0005
996	HOGAN WAY	995 PALMER DRIVE	999 MICKELSON DRIVE	0.193		7	
995	PALMER DRIVE	997 WOODS DRIVE	E SUBDIVISION BDRY (DANTONI RD)	0.203		7	
997	WOODS DRIVE	998 NICKLAUS DRIVE	996 HOGAN WAY	0.194		7	
823	KATRINA DRIVE	999 MICKELSON DRIVE	SUBDIVISION BDRY (DANTONI RANCH ESTATES NO	0.111		7	
572	TREVOR DRIVE	999 MICKELSON DRIVE	SUBDIVISION BDRY (BUTLER ESTATES)	0.073		7	
10000	PAR COURT	823 KATRINA DRIVE	END	0.027		7	
				ADDED SEGMENTS	1.302		
ADDED SEGMENTS							
10029	ALDERSGATE DRIVE	10034 FINSBURY WAY	10036 LONDON WAY	0.247		7	PLUMAS LAKE PHASE 8
10034	FINSBURY WAY	10029 ALDERSGATE DRIVE	S SUBDIVISION BDRY	0.138		7	TM2021-0006
10030	BASINGHALL DRIVE	10034 FINSBURY WAY	10028 ABBEY WAY	0.196		7	
10028	ABBAY WAY	10029 ALDERSGATE DRIVE	10030 BASINGHALL DRIVE	0.055		7	
10036	LONDON WAY	10029 ALDERSGATE DRIVE	10033 CAMOMILE DRIVE	0.109		7	
681	LEIGHTON GROVE DRIVE	10036 LONDON WAY	E SUBDIVISION BDRY (RIVER OAKS BLVD)	0.087		7	
10035	KINGS COURT	681 LEIGHTON GROVE DRIVE	END	0.066		7	
10032	BOND WAY	10033 CAMOMILE DRIVE	681 LEIGHTON GROVE DRIVE	0.070		7	
10033	CAMOMILE DRIVE	10034 FINSBURY WAY	10032 BOND WAY	0.298		7	
				ADDED SEGMENTS	1.263		
ADDED SEGMENTS							
10005	CHELSEA COURT	898 MINORIES DRIVE	END	0.065		7	PLUMAS LAKE PHASE 4
979	CROWDER WAY	898 MINORIES DRIVE	NW SUBDIVISION BDRY	0.070		7	TM2015-0002
898	MINORIES DRIVE	S SUBDIVISION BDRY (PLUMAS LAKE 2B-2A)	N SUBDIVISION BDRY (PM2004-09)	0.237		7	
10003	DEVON COURT	898 MINORIES DRIVE	END	0.050		7	
10004	MITRE COURT	898 MINORIES DRIVE	END	0.050		7	
917	PARKERSON WAY	NW SUBDIVISION BDRY	CROWDER WAY	0.092		7	
				ADDED SEGMENTS	0.563		
ADDED SEGMENTS							
898	MINORIES DRIVE	NW SUBDIVISION BDRY	S/E SUBDIVISION BDRY	0.249		7	PLUMAS LAKE PHASE 5
979	CROWDER WAY	898 MINORIES DRIVE	S SUBDIVISION BDRY	0.158		7	TM2020-0005
915	IVY HATCH WAY	SW SUBDIVISION BDRY	979 CROWDER WAY	0.122		7	
980	EXETER COURT	915 IVY HATCH WAY	END	0.040		7	
978	JARDINE COURT	979 CROWDER WAY	END	0.070		7	
977	WAGGONER COURT	S SUBDIVISION BDRY	END	0.075		7	
				ADDED SEGMENTS	0.713		
ADDED SEGMENTS							
10002	REDFORD WAY	N SUBDIVISION BDRY	END (CUL-DE-SAC)	0.117		7	PLUMAS LAKE PHASE 6
10001	FLEET COURT	10002 REDFORD WAY	END	0.040		7	TM2020-0006
				ADDED SEGMENTS	0.157		

**2024 YUBA COUNTY
ADDED / ABANDONED /
VACATED ROADS
CLASSIFICATION CHANGES**

ROAD NUMBER	ROAD NAME	FROM [NUMBER AND NAME]	TO [NUMBER AND NAME]	LENGTH	VALUE	FUNC. CLASS	DESCRIPTION
697	ISLESWORTH WAY	N SUBDIVISION BDRY	982 BOSWELL WAY	0.134		7	PLUMAS LAKE PHASE 7
698	STEPNEY WAY	N SUBDIVISION BDRY	687 NOTTING HILL WAY	0.286		7	TM2021-0002
687	NOTTING HILL WAY	982 BOSWELL WAY	698 STEPNEY WAY	0.051		7	
982	BOSWELL WAY	682 KENSINGTON DRIVE	687 NOTTING HILL WAY	0.052		7	
682	KENSINGTON DRIVE	S SUBDIVISION BDRY	NW SUBDIVISION BDRY	0.260		7	
983	QUAY COURT	687 NOTTING HILL WAY	END	0.037		7	
725	WREN COURT	697 ISLESWORTH WAY	END	0.028		7	
981	CANNON COURT	698 STEPNEY WAY	END	0.026		7	
			ADDED SEGMENTS	0.674			
787	ATHERTON WAY	W SUBDIVISION BOUNDRY	922 LOS ALTOS COURT	0.030		7	PLUMAS RANCH VILLAGE 6
788	WESTPORT WAY	W SUBDIVISION BOUNDRY	919 PACIFIC GROVE WAY	0.026		7	TM2004-23
789	DEL NORTE WAY	W SUBDIVISION BDRY	992 PALO ALTO CT / 989 PACIFIC GROVE WAY INT.	0.069		7	
989	PACIFIC GROVE WAY	787 ATHERTON / 922 LOS ALTOS CT INTERSECTION	960 DEL NORTE WAY / PALO ALTO CT INTERSECTION	0.201		7	
990	LOS ALTOS COURT	787 ATHERTON / 989 PACIFIC GROVE WAY INTERSE	END	0.054		7	
991	SAN ANSELMO COURT	989 PACIFIC GROVE WAY	END	0.089		7	
992	PALO ALTO COURT	960 DEL NORTE WAY / 989 PACIFIC GROVE WAY INT	END	0.054		7	
			ADDED SEGMENTS	0.521			
967	RIO GRANDE DRIVE	SE SUBDIVISION BDRY (RIVERSIDE MEADOWS V.3)	765 CIMARRON DRIVE	0.101		7	RIVERSIDE MEADOWS VILLAGE 4
10025	OHIO COURT	967 RIO GRANDE DRIVE	END	0.036		7	TM2004-0039
10026	GOLD RUSH COURT	765 CIMARRON DRIVE	10018 BOB HAYES DRIVE	0.045		7	
10027	YUKON COURT	967 RIO GRANDE DRIVE	END	0.036		7	
10021	WABASH COURT	967 RIO GRANDE DRIVE	END	0.053		7	
10024	SAN JUAN COURT	E SUBDIVISION BDRY (CIMARRON DRIVE)	END	0.060		7	
10023	MADISON COURT	N SUBDIVISION BDRY (CIMARRON DRIVE)	END	0.115		7	
10022	SPRING CREEK WAY	10023 MADISON COURT	W SUBDIVISION BDRY	0.092		7	
			ADDED SEGMENTS	0.537			



EXHIBIT C
Yuba County
Functional Road Classifications
County Overview Page 1 of 8



Legend

- RURAL MINOR ARTERIAL
- PRIVATE
- RURAL MINOR COLLECTOR
- RURAL MAJOR COLLECTOR
- RURAL PRINCIPAL ARTERIAL
- URBAN MINOR ARTERIAL
- URBAN COLLECTOR
- URBAN PRINCIPAL ARTERIAL
- MARYSVILLE
- WHEATLAND
- NOT COUNTY MAINTAINED
- Places
- Yuba Parcels
- Yuba County Boundary

YUBA COUNTY
Drawn By: KEG
Date: 4-28-2008, rev. 3-27-2025
File: H:\Common\ENGINEERING\GIS\Kathy's_gis_working
Functional_ClassV_ClassMappg1.mxd

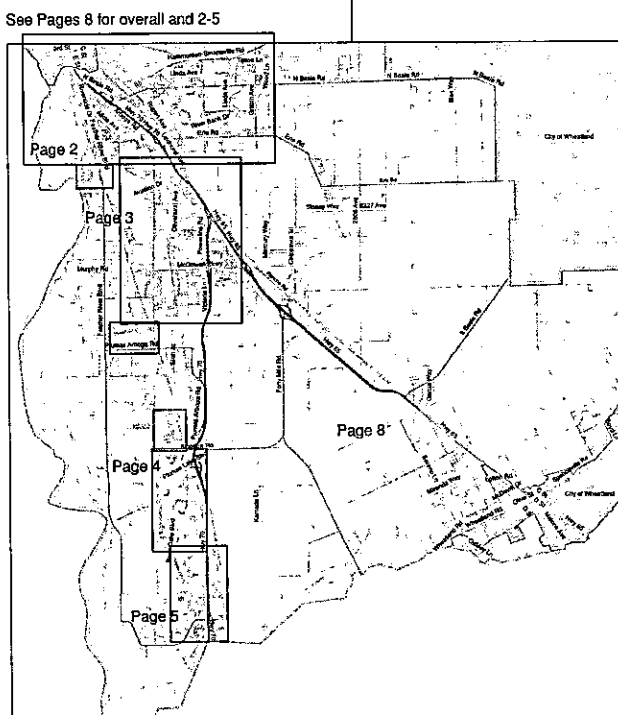
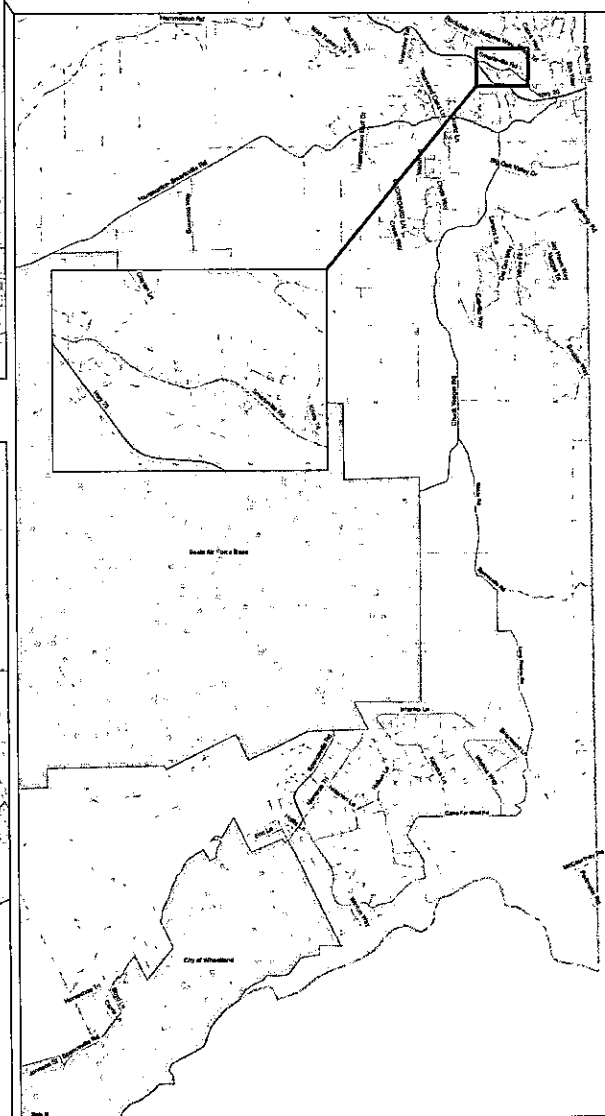
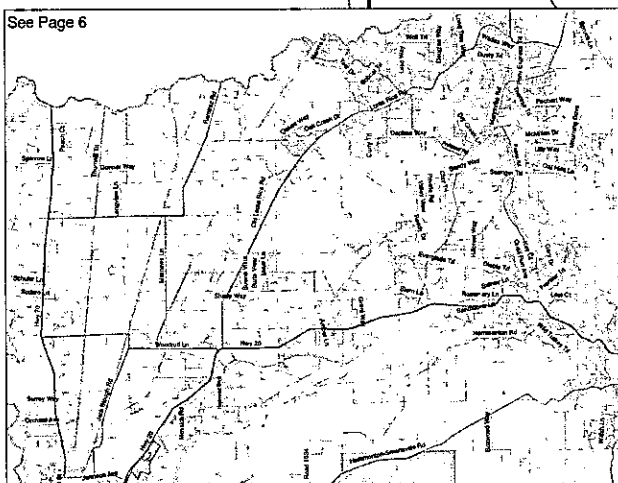
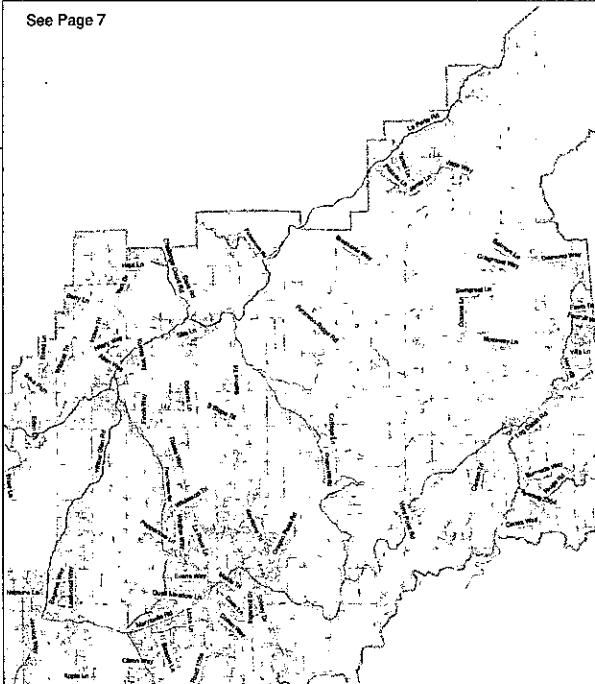
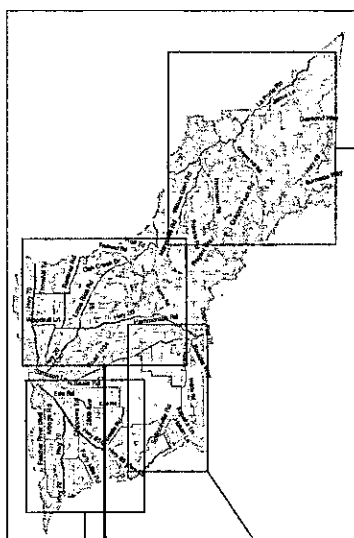
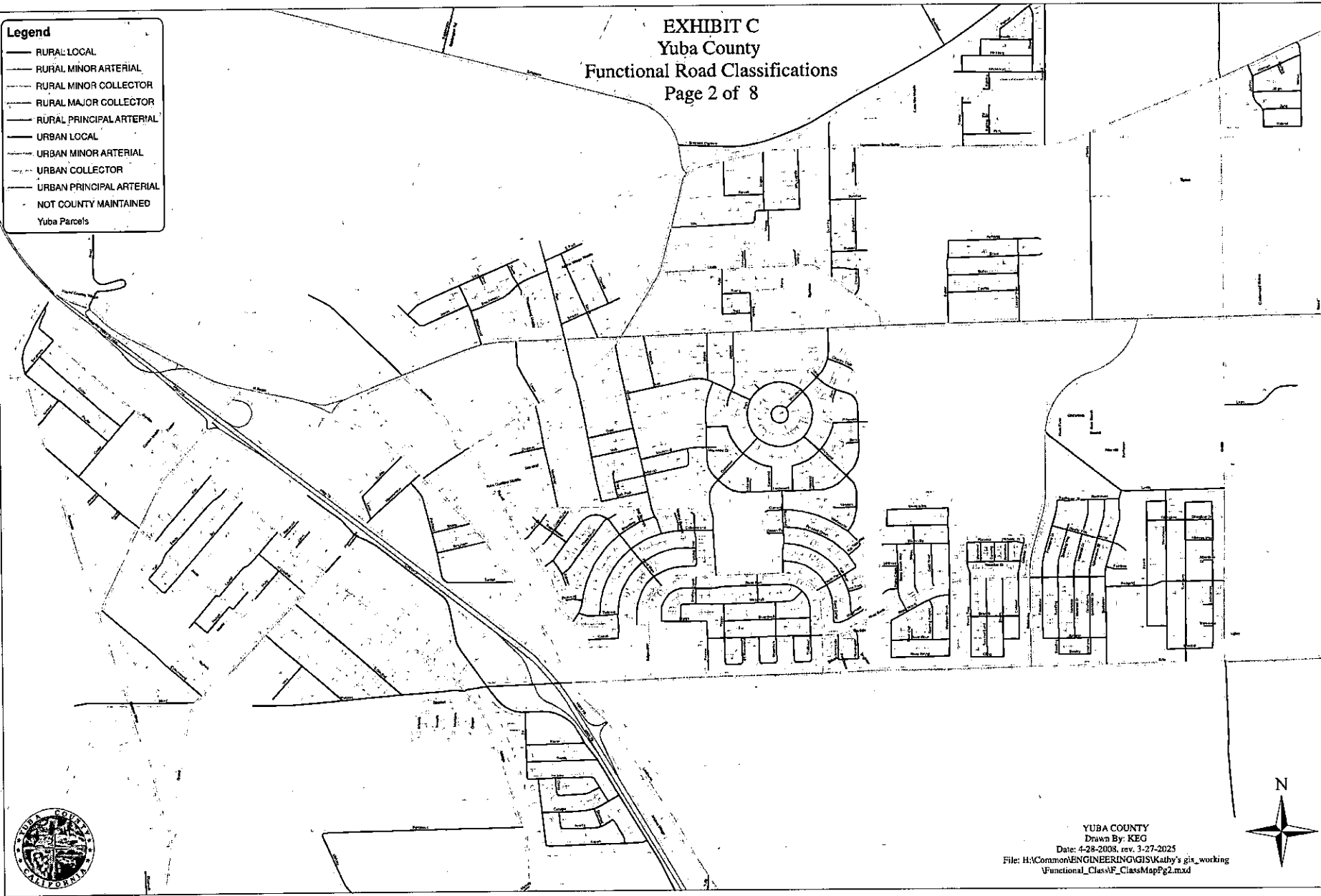

EXHIBIT C
Yuba County
Functional Road Classifications
Page 2 of 8

- Legend**
- RURAL LOCAL
 - RURAL MINOR ARTERIAL
 - RURAL MINOR COLLECTOR
 - RURAL MAJOR COLLECTOR
 - RURAL PRINCIPAL ARTERIAL
 - URBAN LOCAL
 - URBAN MINOR ARTERIAL
 - URBAN COLLECTOR
 - URBAN PRINCIPAL ARTERIAL
 - - - NOT COUNTY MAINTAINED
 - Yuba Parcels



YUBA COUNTY
Drawn By: KEG
Date: 4-28-2008, rev. 3-27-2025
File: H:\Common\ENGINEERING\GIS\Kathy's gis_working
Functional_Class\IF_ClassMapPg2.mxd





EXHIBIT C
Yuba County
Functional Road Classifications
Page 3 of 8

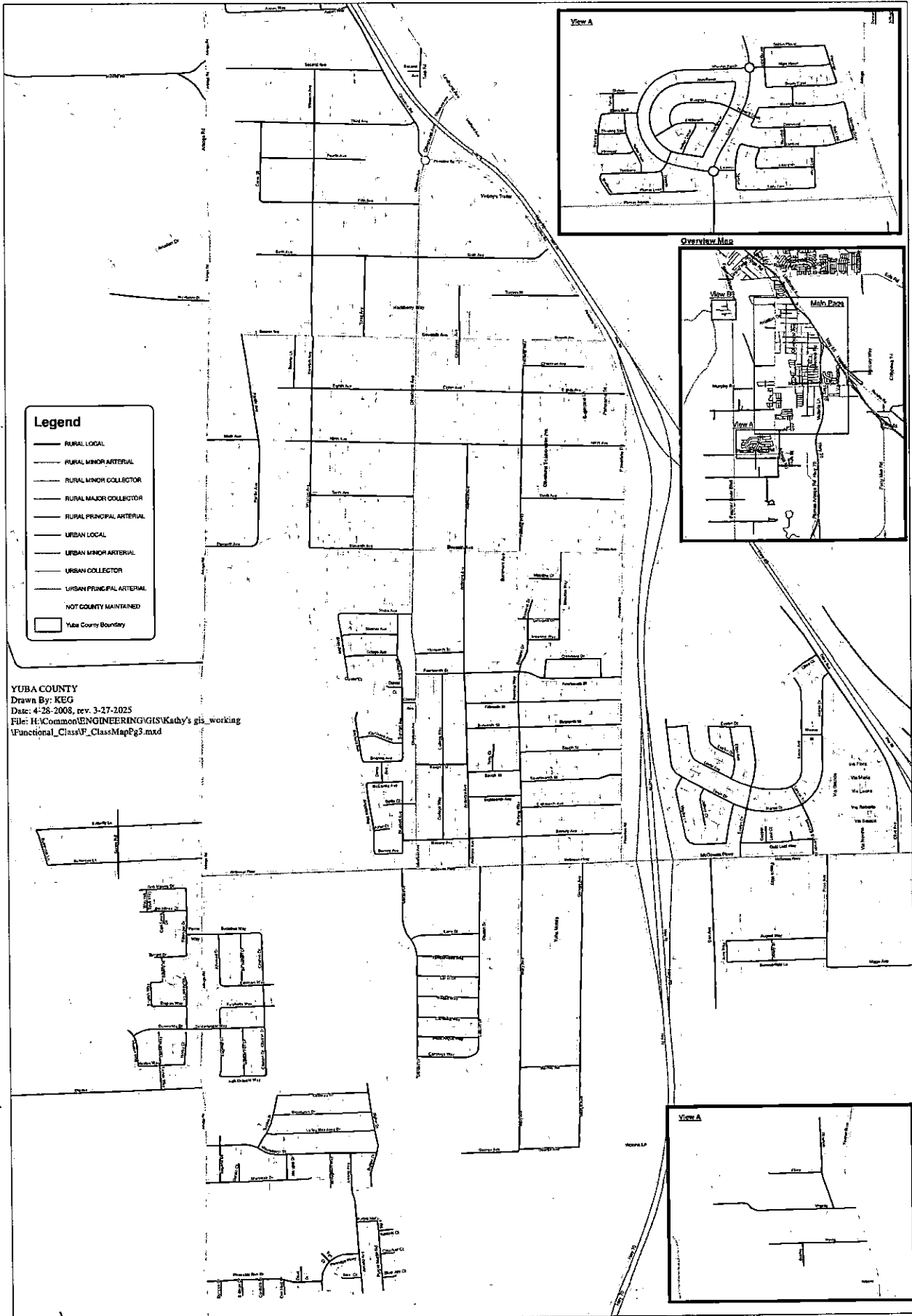

Legend

- RURAL LOCAL
- RURAL MINOR ARTERIAL
- RURAL MINOR COLLECTOR
- RURAL MAJOR COLLECTOR
- RURAL PRINCIPAL ARTERIAL
- URBAN LOCAL
- URBAN MINOR ARTERIAL
- URBAN COLLECTOR
- URBAN PRINCIPAL ARTERIAL
- NOT COUNTY MAINTAINED
- Yuba County Boundary

YUBA COUNTY
 Drawn By: KEG
 Date: 4-28-2008, rev. 3-27-2025
 File: H:\Common\ENGINEERING\GIS\Kathy's gis_working
 \Functional_ClassV_ClassMapPg3.mxd

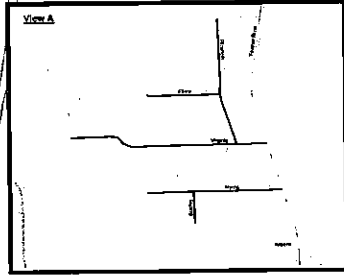
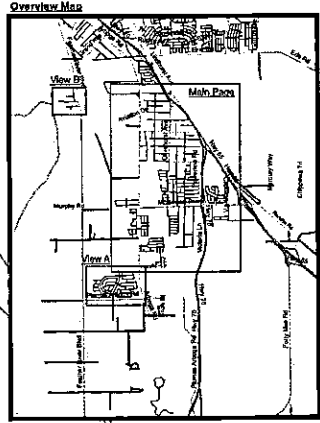
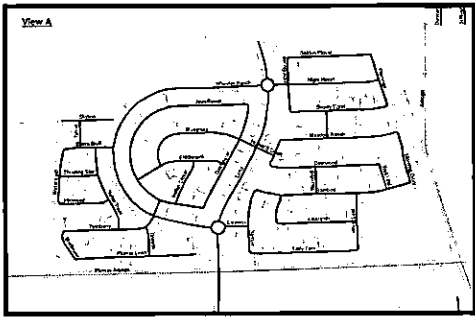
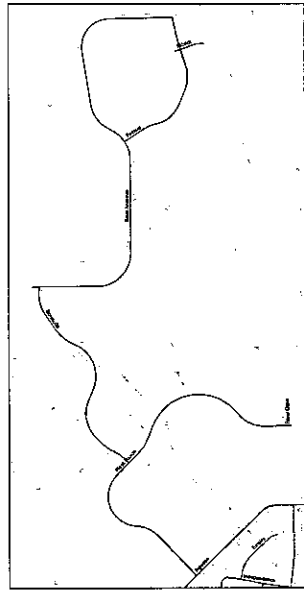
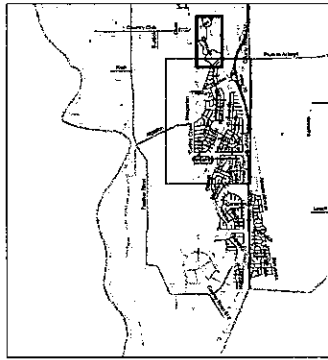



EXHIBIT C
Yuba County
Functional Road Classifications
Plumas Lake area Page 4 of 8



YUBA COUNTY
Drawn By: KEG
Date: 4-28-2008, rev. 3-27-2025
File: H:\Common\ENGINEERING\GIS\Kathy's_gis_working
Functional_Class\F_ClassMapPg4.mxd

Legend

- RURAL LOCAL
- RURAL MINOR ARTERIAL
- RURAL MINOR COLLECTOR
- RURAL MAJOR COLLECTOR
- RURAL PRINCIPAL ARTERIAL
- URBAN LOCAL
- URBAN MINOR ARTERIAL
- URBAN COLLECTOR
- URBAN PRINCIPAL ARTERIAL
- NOT COUNTY MAINTAINED
- Yuba Parcels
- Yuba County Boundary

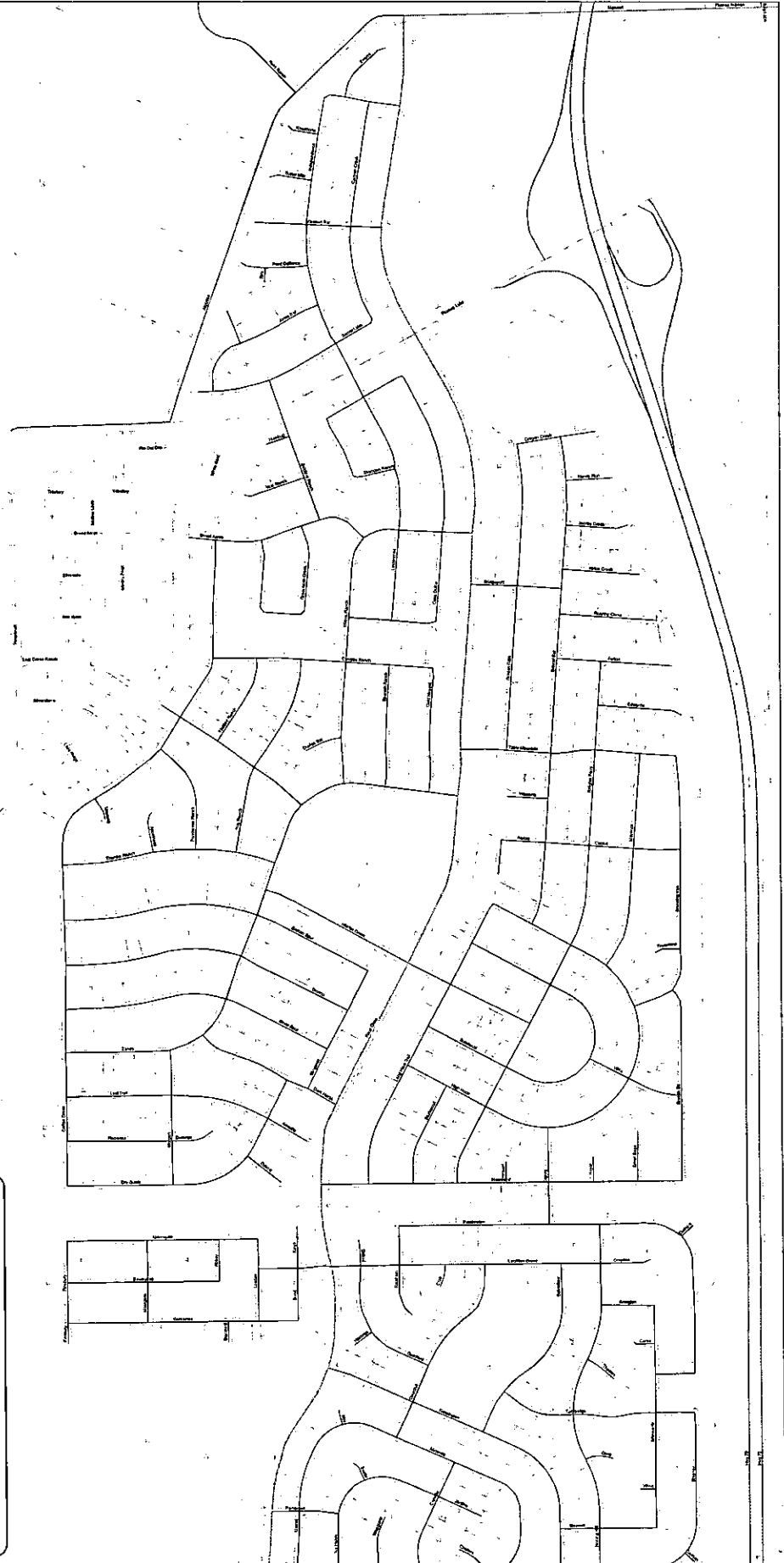



EXHIBIT C
Yuba County
Functional Road Classifications
Plumas Lake area Page 5 of 8

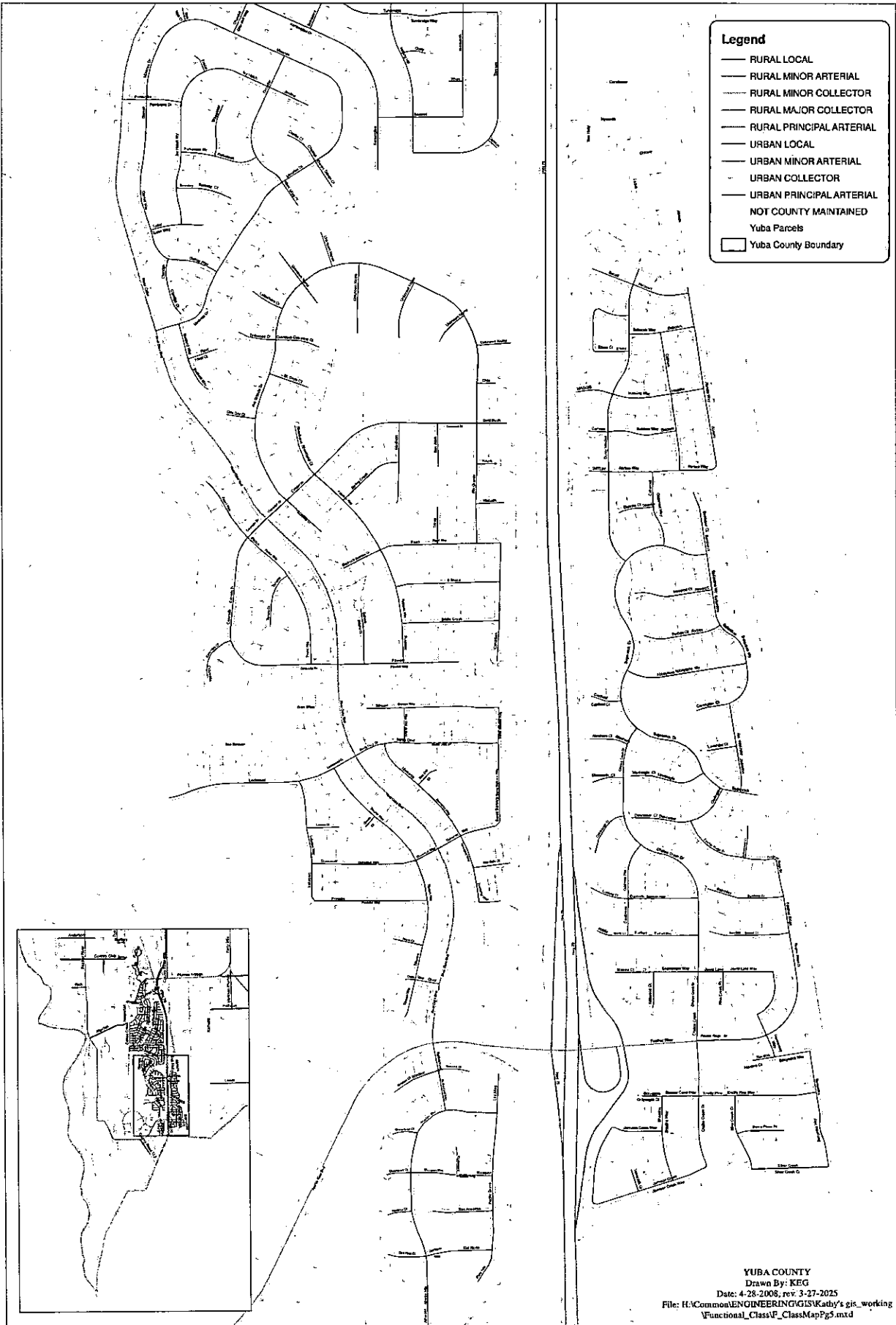
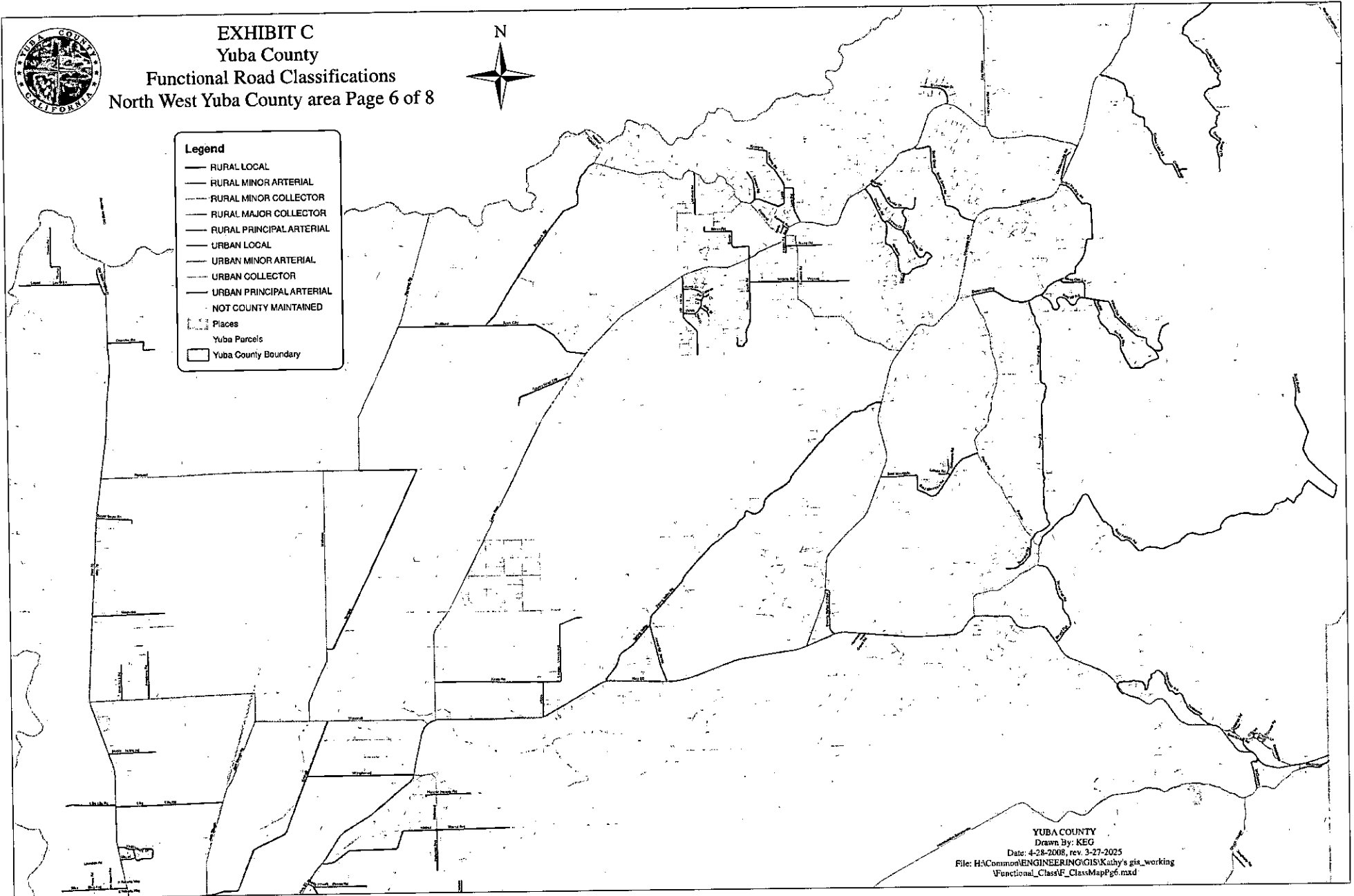



EXHIBIT C
Yuba County
Functional Road Classifications
North West Yuba County area Page 6 of 8



- Legend**
- RURAL LOCAL
 - RURAL MINOR ARTERIAL
 - RURAL MINOR COLLECTOR
 - RURAL MAJOR COLLECTOR
 - RURAL PRINCIPAL ARTERIAL
 - URBAN LOCAL
 - URBAN MINOR ARTERIAL
 - URBAN COLLECTOR
 - URBAN PRINCIPAL ARTERIAL
 - NOT COUNTY MAINTAINED
 - Places
 - Yuba Parcels
 - Yuba County Boundary



YUBA COUNTY
Drawn By: KEG
Date: 4-28-2008, rev. 3-27-2025
File: H:\Common\ENGINEERING\GIS\Kathy's_gis_working
Functional_ClassF_ClassMapfg6.mxd



EXHIBIT C
Yuba County
Functional Road Classifications
North East Yuba County area Page 7 of 8



- Legend**
- RURAL LOCAL
 - RURAL MINOR ARTERIAL
 - RURAL MINOR COLLECTOR
 - RURAL MAJOR COLLECTOR
 - RURAL PRINCIPAL ARTERIAL
 - URBAN LOCAL
 - URBAN MINOR ARTERIAL
 - URBAN COLLECTOR
 - URBAN PRINCIPAL ARTERIAL
 - - - NOT COUNTY MAINTAINED
 - Yuba Parcels
 - Yuba County Boundary

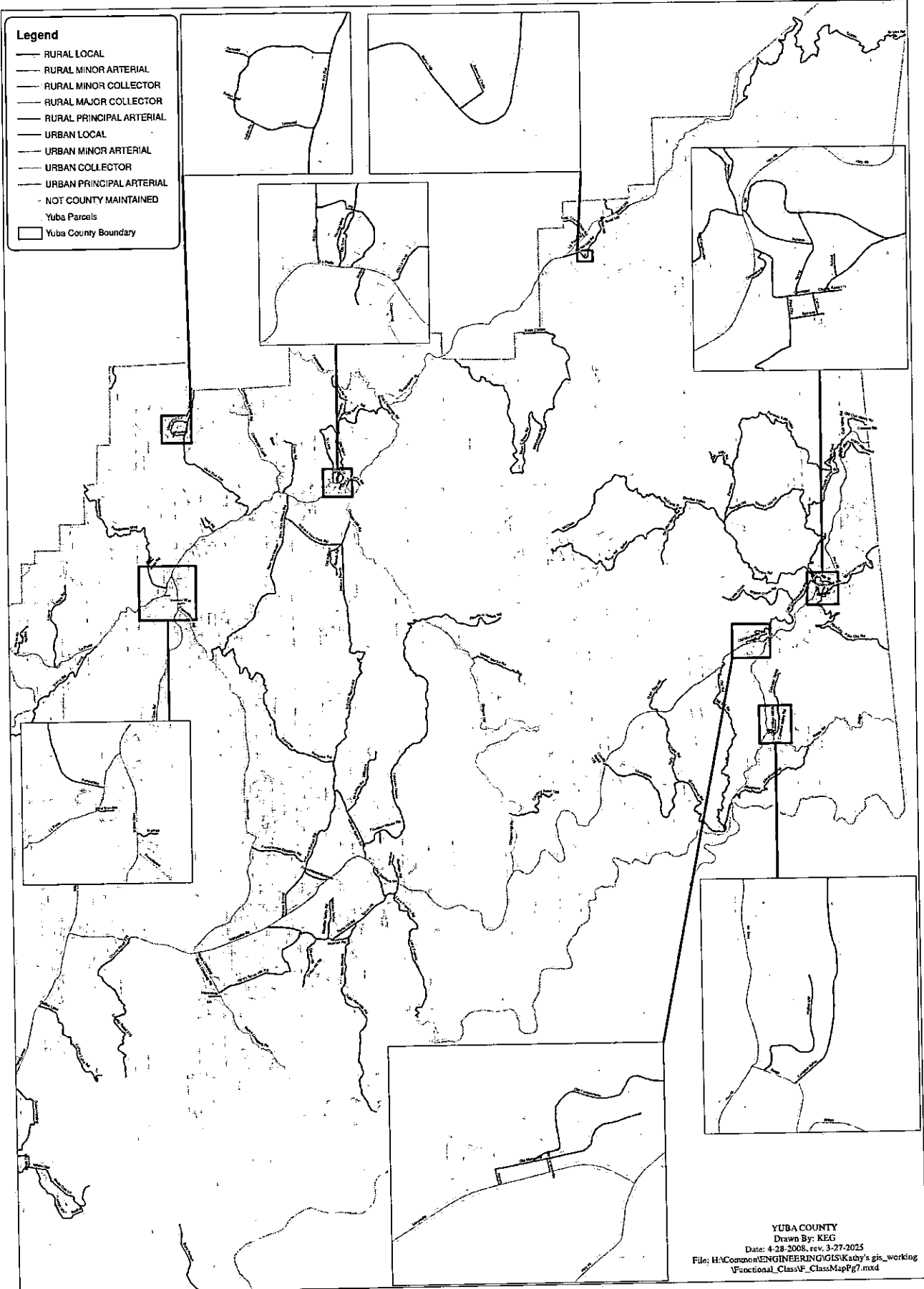
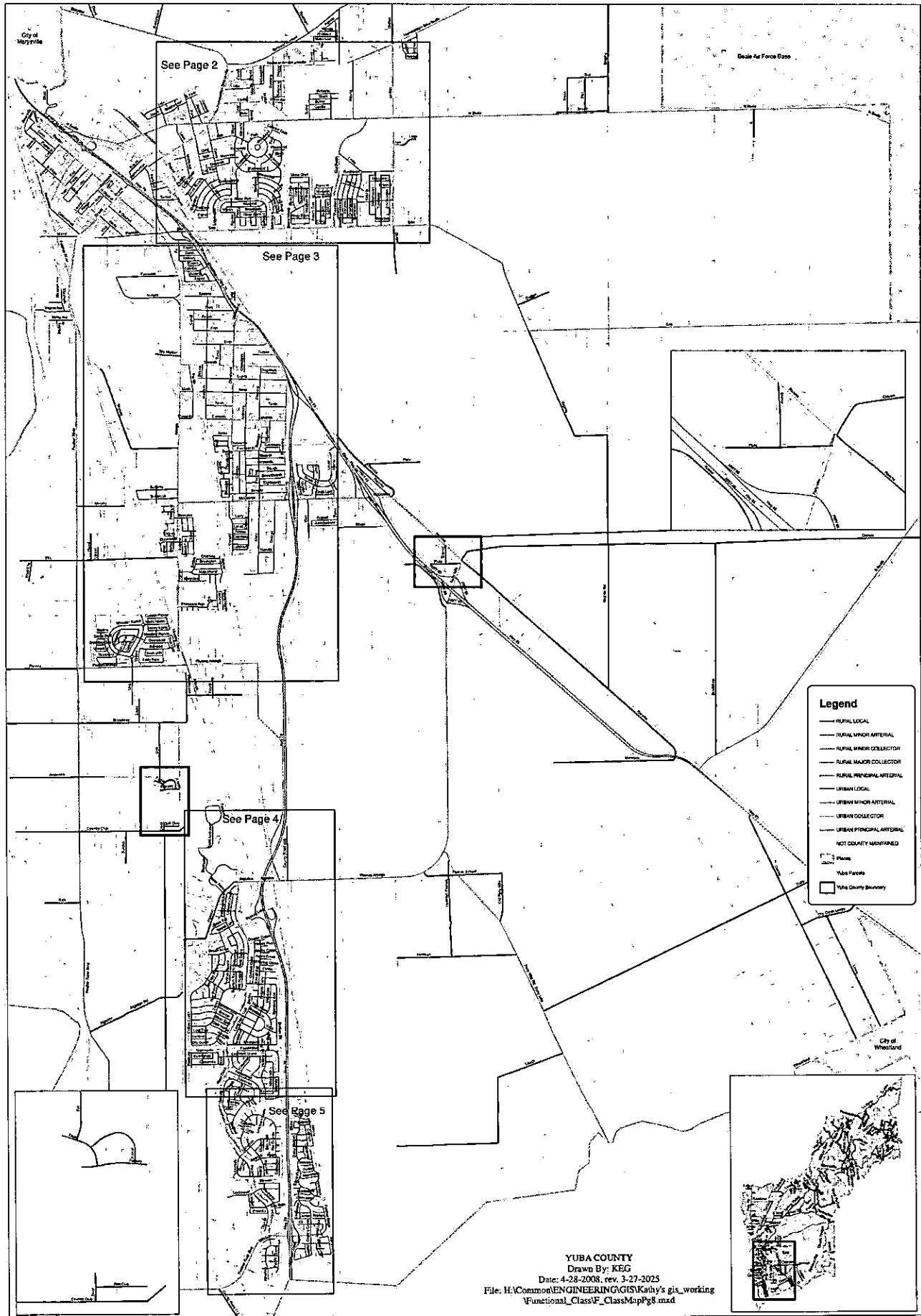



EXHIBIT C
 Yuba County
 Functional Road Classifications
 South West Yuba County Page 8 of 8



- Legend**
- RURAL LOCAL
 - RURAL MINOR ARTERIAL
 - RURAL MINOR COLLECTOR
 - RURAL MAJOR COLLECTOR
 - RURAL PRINCIPAL ARTERIAL
 - URBAN LOCAL
 - URBAN MINOR ARTERIAL
 - URBAN COLLECTOR
 - URBAN PRINCIPAL ARTERIAL
 - NOT COUNTY MAINTAINED
 - Place
 - Yuba Parcels
 - Yuba County Boundary